



# Parts list Mirage

## Contents

Boiler related parts .....	2
Top of boiler .....	2
Adjustable restrictor.....	3
Below boiler .....	4
Boiler fill .....	5
Inlet manifold .....	6
Mix block .....	7
Mix block tubing.....	8
Groups .....	9
Group valve .....	9
Group without progressive pre-infusion cylinder .....	10
Group with progressive pre-infusion cylinder (PPIC) .....	11
Idrocompressor .....	12
Upper lines .....	12
Lower lines; flush version only .....	13
Group, until 2009 .....	14
Group interior, until 2009 .....	15
Group, after 2009 .....	16
Group interior, after 2009 .....	17
Manifold .....	18
Electrics.....	19
Main controller, mains switch, timer .....	19
Flow meter .....	20
Touchpads, control lights, hot water switch, gauge.....	21
Bastone lever, old model .....	22
Bastone lever, new model.....	23
Heating element, SSR, pressostat .....	24
Valves and wands .....	25
Steam valve and wand .....	25
Steam valve interior .....	26
Hot water wand.....	27
Pump with motor.....	28
Pump with motor; 220-240VAC, 60Hz .....	29
Foot operated steam valve .....	30
Pedal parts.....	30
Other parts .....	31
Milk pitcher tray .....	32
Body parts.....	33

Explanation for tables:

nip	not in picture
s.st.	stainless steel
#	first 3 digits of machine number
V (as start of parts number)	part no longer used, replacement parts available
X (as start of parts number)	no longer available (as separate part)
Z (as start of parts number)	part no longer used, still available, may run out

Order parts via: [spareparts@keesvanderwesten.com](mailto:spareparts@keesvanderwesten.com)

**When ordering parts, always specify the machine number the part is meant for.  
Refer to this parts-list (revision date ....., 2015) when ordering.**



## Boiler related parts

### Top of boiler

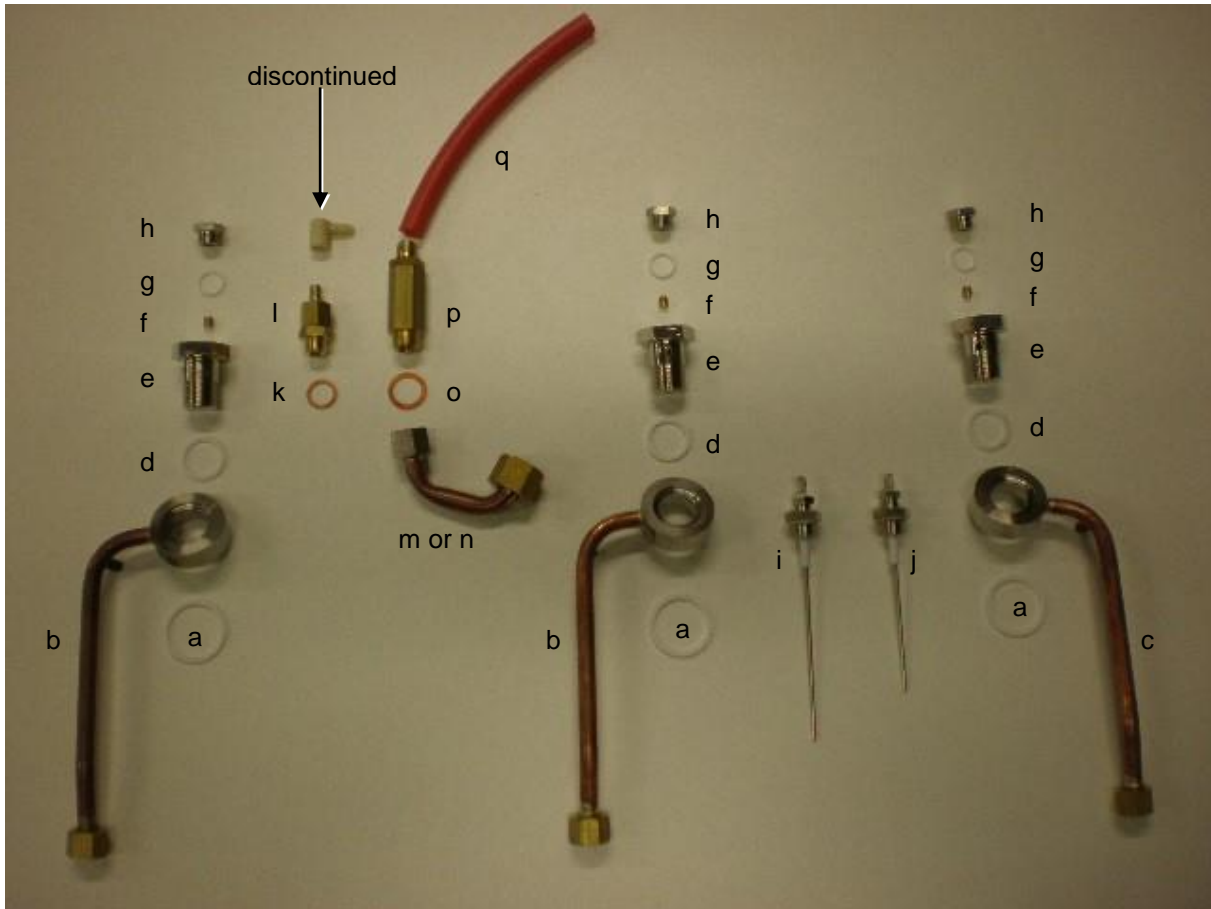

Part		Number	remark
a	Teflon O-ring between tubing and boiler; 3/4, 36x30x2.25	M-B080	
b	copper tubing 10mm; group ↔ upper banjo	M-B062	left (and middle)
c	copper tubing 10mm; group ↔ upper banjo	M-B066	right
d	Teflon O-ring on upper banjo; 1/2, 27x21x2	M-B073	
e	chromed brass upper banjo plug; 1/2	M-B067	
f	brass jet; 1.5mm diameter, M6x6	ZMSR-B034-15B	MSR-B034-15
	s.st. jet; 1,5mm diameter, M6x6	MSR-B034-15	
g	Teflon O-ring on banjo cap; 1/4	MS-B074	
h	chromed brass plug; 1/4	MSR-B068	
i	s.st. safety level sensor; 150mm, faston	MSR-E028-C	
j	s.st. operational level sensor; 125mm, faston	MSR-E029-C	
k	copper ring; 1/4	MSR-B079	
l	brass anti-vacuum valve; 1/4M - hose pilar	MSR-B033	
m	copper tubing 12mm; boiler ↔ safety pressure valve	M-B081-D	Duette only
n	copper tubing 12mm; boiler ↔ safety pressure valve	MR-B081-T	Triplette only
o	copper ring; 3/8	MSR-B078	
p	brass safety pressure valve; 3/8 - hose pilar	MR-B032	
q	red silicone reinforced hose; 8x14.5, 18cm	M-B070-L	



## Adjustable restrictor

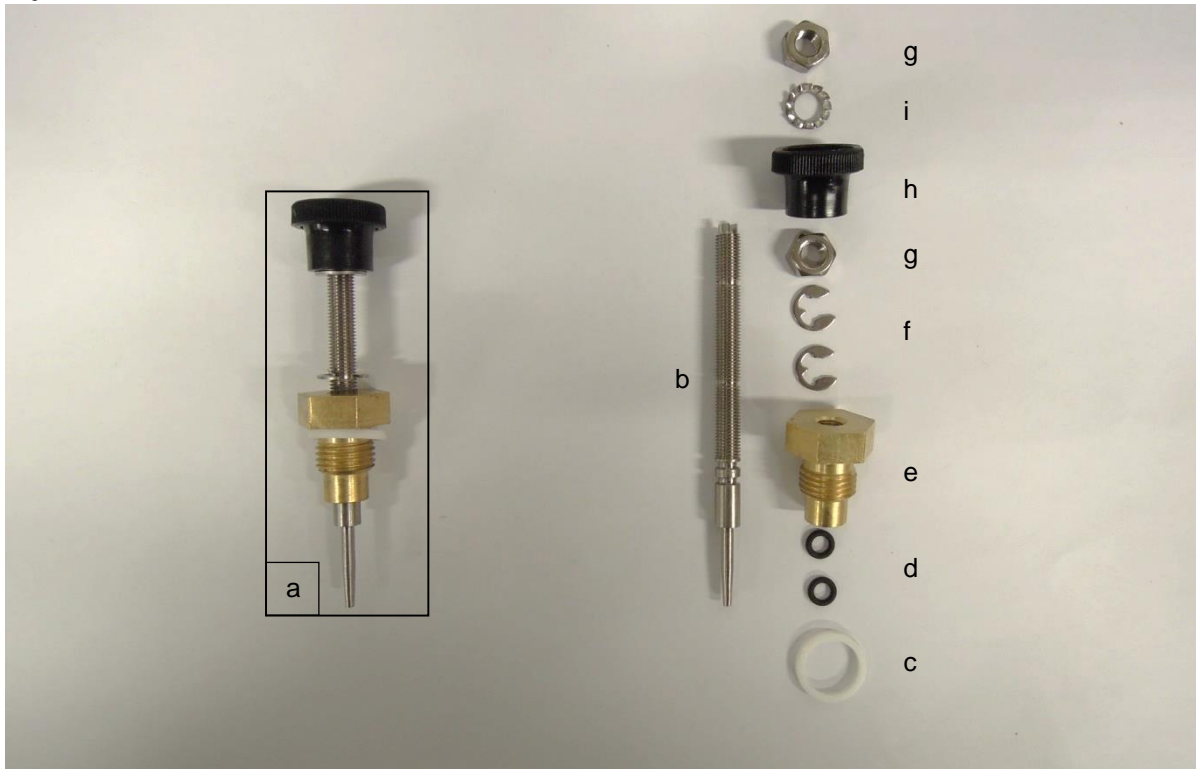

	Part	Number	remark
a	adjustable restrictor; blunt needle, complete	M-B037-C	
b	s.st. restrictor needle; blunt	M-B037-N	
c	Teflon O-ring; 1/4	MS-B074	
d	Viton O-rings on restrictor needle; 4x1.5, 2pcs	M-B037-O	set of 2 O-rings
e	brass needle housing	M-B037-H	
f	s.st. circlip; din6799 M5	C-VA-M5	
g	s.st. nut; din934, M6fine	C-MH-M6F	0.75 thread!!
h	black plastic knob	M-B037-K	
i	s.st. lock washer; din6798A M6	C-RT-M6	



**Below boiler**

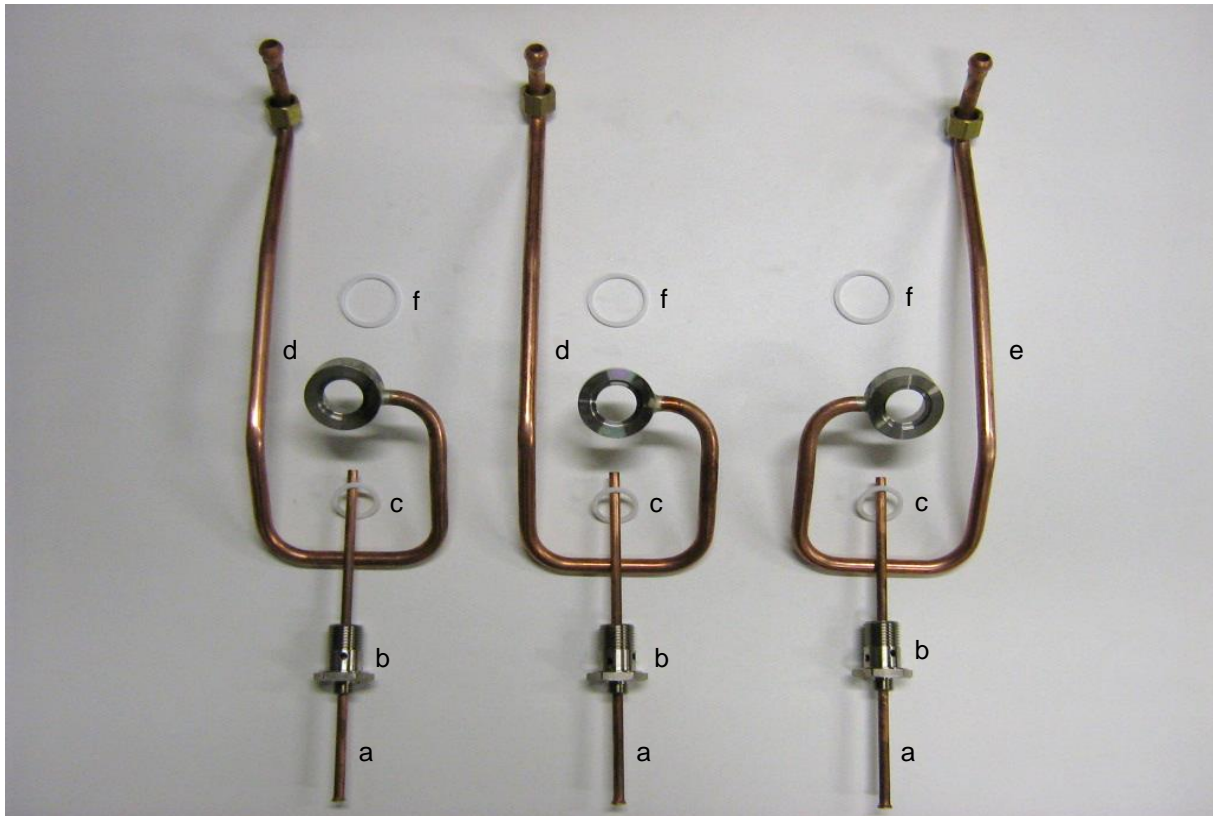

	<b>Part</b>	<b>Number</b>	<b>remark</b>
a	copper tubing 6mm; flared inlet tube	M-B053	
b	chromed brass lower banjo plug; 1/4M-1/2M	M-B069	
c	Teflon O-ring; 1/2 (27x21x2)	M-B073	
d	copper tubing 10mm; group ↔ lower banjo left & middle	M-B069	
e	copper tubing 10mm; group ↔ lower banjo right	M-B065	
f	Teflon O-ring; 3/4 (36x30x2.25)	M-B080	



## Boiler fill

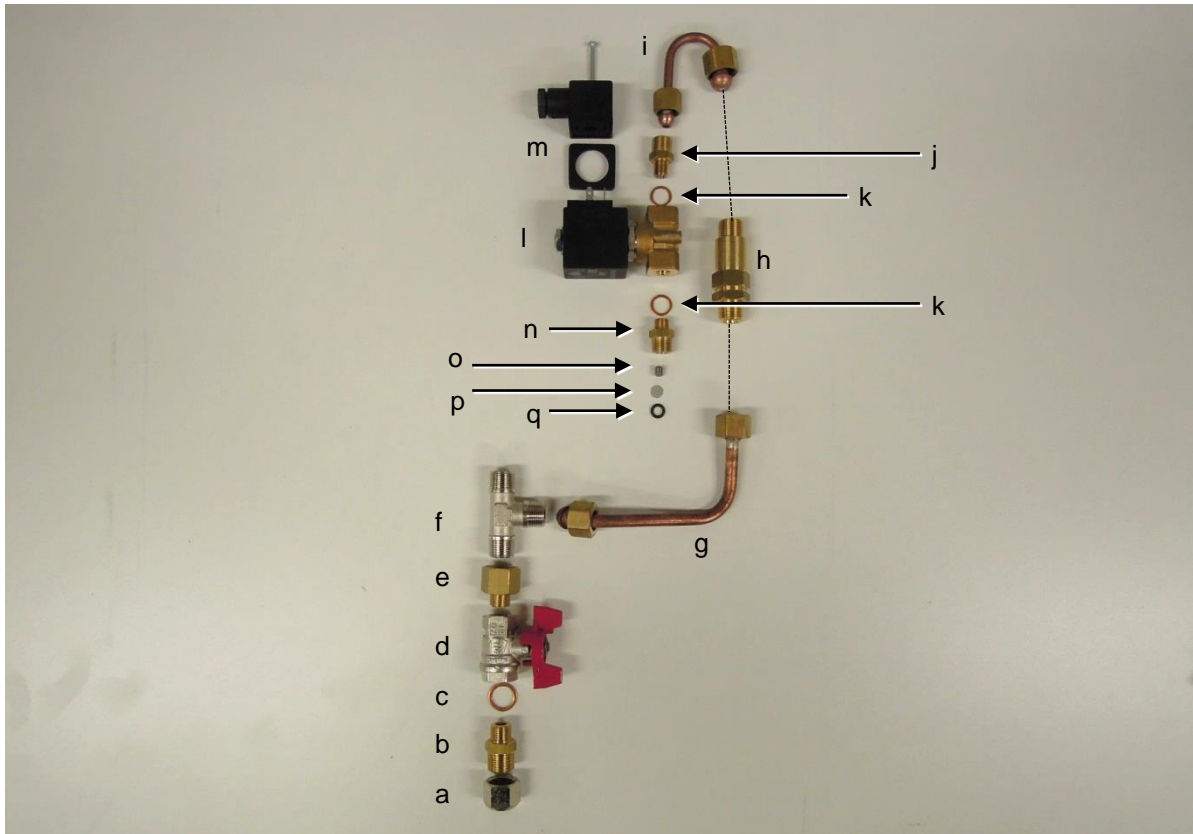

	Part	Number	remark
a	chromed brass plug; 3/8F	MSR-B077	
b	brass fitting; 1/4M-3/8M	MSR-S037	
c	copper ring; 1/4	MSR-B079	
d	nickel plated brass valve; 1/4F-1/4F, butterfly handle	MSR-B076	
e	brass fitting; 3/8F-1/4M	M-B010	
f	nickel plated brass T-fitting; 3/8M-3/8M-3/8M	MR-B075	
g	copper tubing 8mm; one-way valve ↔ T-fitting	M-B055	
h	brass one-way valve; 3/8M-3/8M	MR-B029	
i	copper tubing 6mm; fill valve ↔ one-way valve	M-B055	
j	brass fitting; 1/8M-1/4M	MSR-S035	
k	copper ring; 1/8	MSR-B082	
l	brass 2-way solenoid valve with coil; 220-240V/50-60Hz	M-E026	2.5mm orifice
m	valve coil-plug with seal and screw	MSR-E024	
n	brass jet housing; 1/8M-1/4M with M6 thread	MSR-B035-B	fill-jet assembly: MSR-B035-C10
o	s.st. jet; 1.0mm diameter, M6x6	MSR-B034-10	
p	s.st. perforated screen for jet	MSR-B036-B	
q	Viton O-ring in jet housing	MSR-G1007-A	



## Inlet manifold

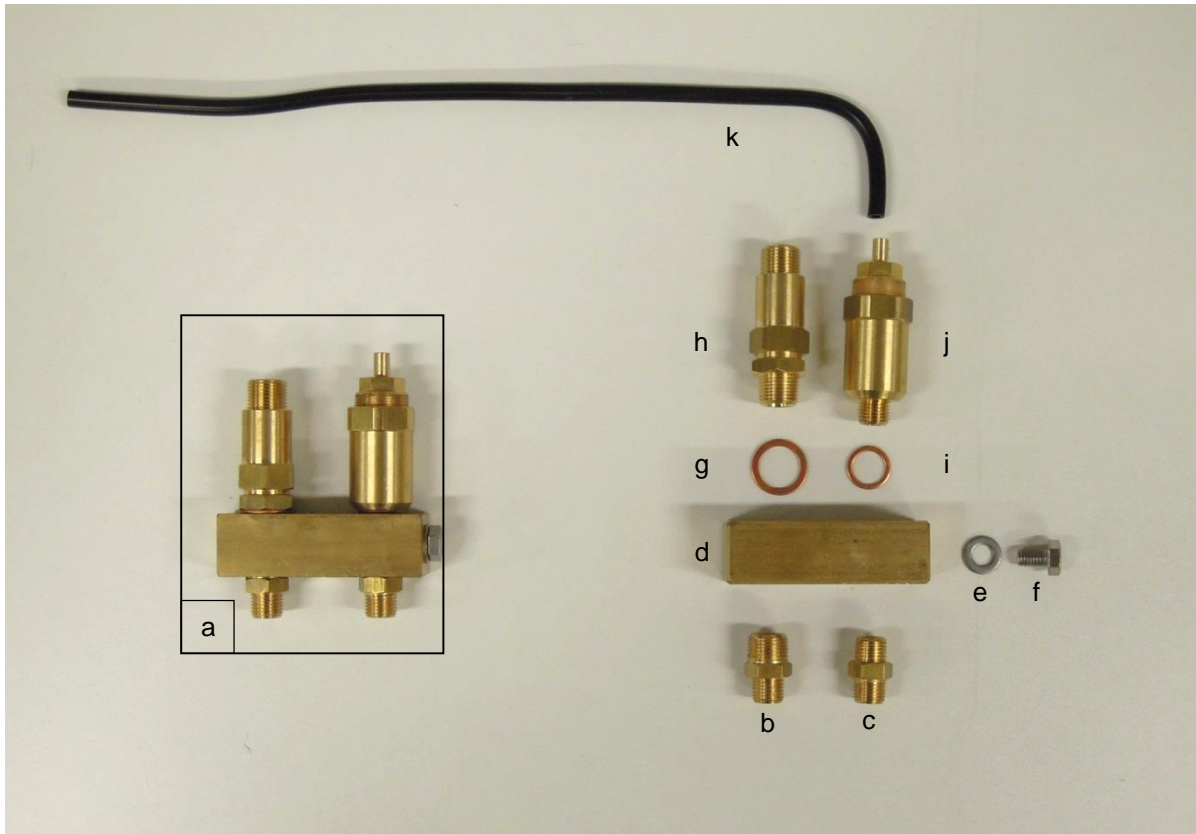

	Part	Number	remark
a	inlet manifold assembly; complete	M-B028-C	
b	brass fitting; 1/4M-3/8M	MSR-S037	
c	brass fitting; 1/4M-1/4M	MSR-S036	
d	brass inlet manifold; bare	M-B028	
e	s.st. washer; din125A M8	C-RS-M8	
f	s.st. bolt; din933 M8x12	C-BT-M8x12	
g	copper ring; 3/8	MSR-B078	
h	brass one-way valve; 3/8M-3/8M	MR-B029	
i	copper ring; 1/4	MSR-B079	
j	brass adjustable expansion valve; 1/4M-hose pilar	M-B030-A	
k	black silicone hose; expansion valve ↔ discharge pipe	C-HS-ZZ4x8	4x8mm, 36cm



## Mix block

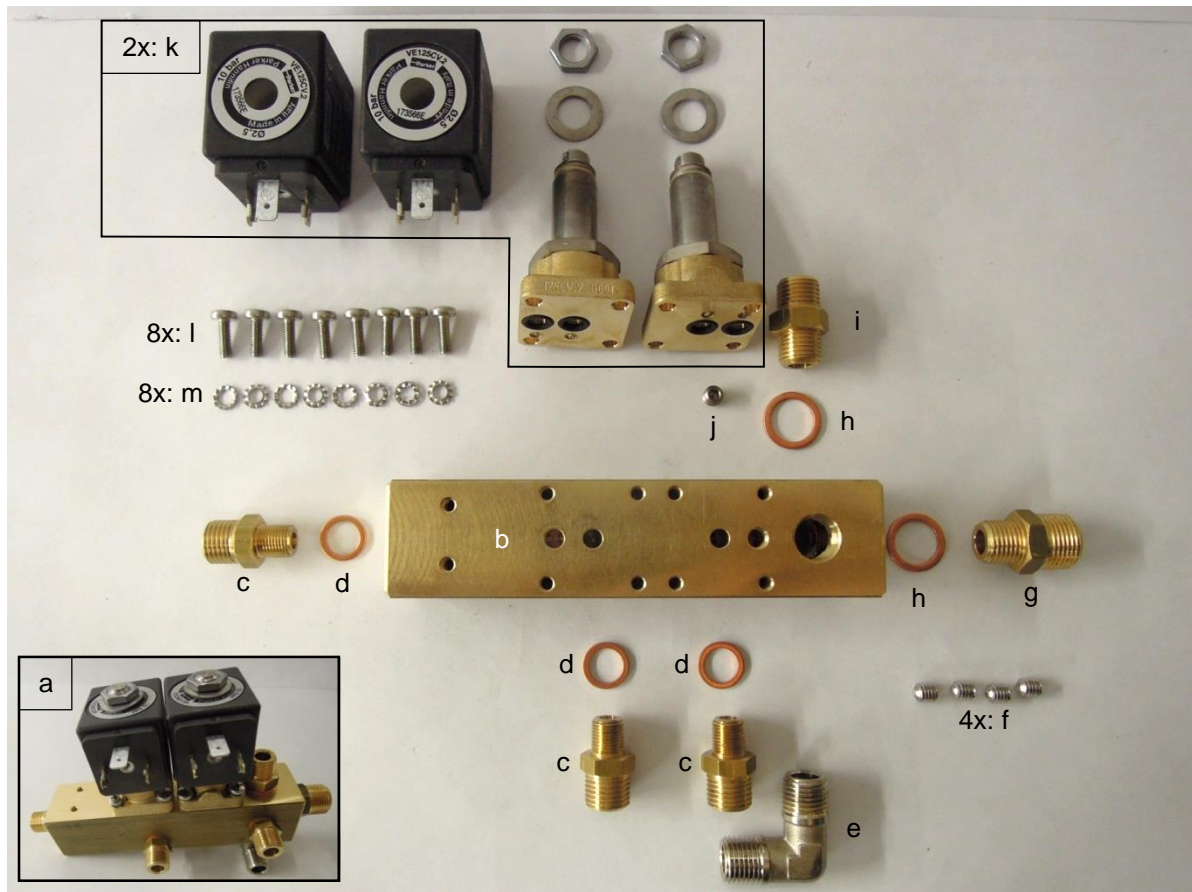

	Part	Number	remark
a	Mirage mix block assembly; complete	M-B039-C	
b	brass Mirage mix block; bare	M-B039	
c	brass fitting; 1/8M-1/4M	MSR-S035	
d	copper ring; 1/8	MSR-B082	
e	nickel plated brass knee fitting: 1/4M-1/4M	MSR-S038	
f	s.st. set screw; din916 M6x6	C-SS-M6x6	
g	brass fitting; 1/4M-3/8M	MSR-S037	
h	copper ring; 1/4	MSR-B079	
i	brass fitting; 1/4M-1/4M	MSR-S036	
j	s.st. jet; M6x6, 0.7mm diameter	MSR-B034-07	
k	brass 2-way solenoid flange valve; complete, 230VAC	VMSR-E026-230	MSR-E026-23S
l	s.st. Philips bolt; din7985 M4x12	C-SK-M4x12	
m	s.st. lock washer; din6798A M4	C-RT-M4	
nip	s.st. 2-way solenoid flange valve; complete, 230VAC	MSR-E026-23S	
	s.st. Philips bolt; din7985 M4x6 (replaces M4x8)	C-SK-M4x6	with above





## Mix block tubing

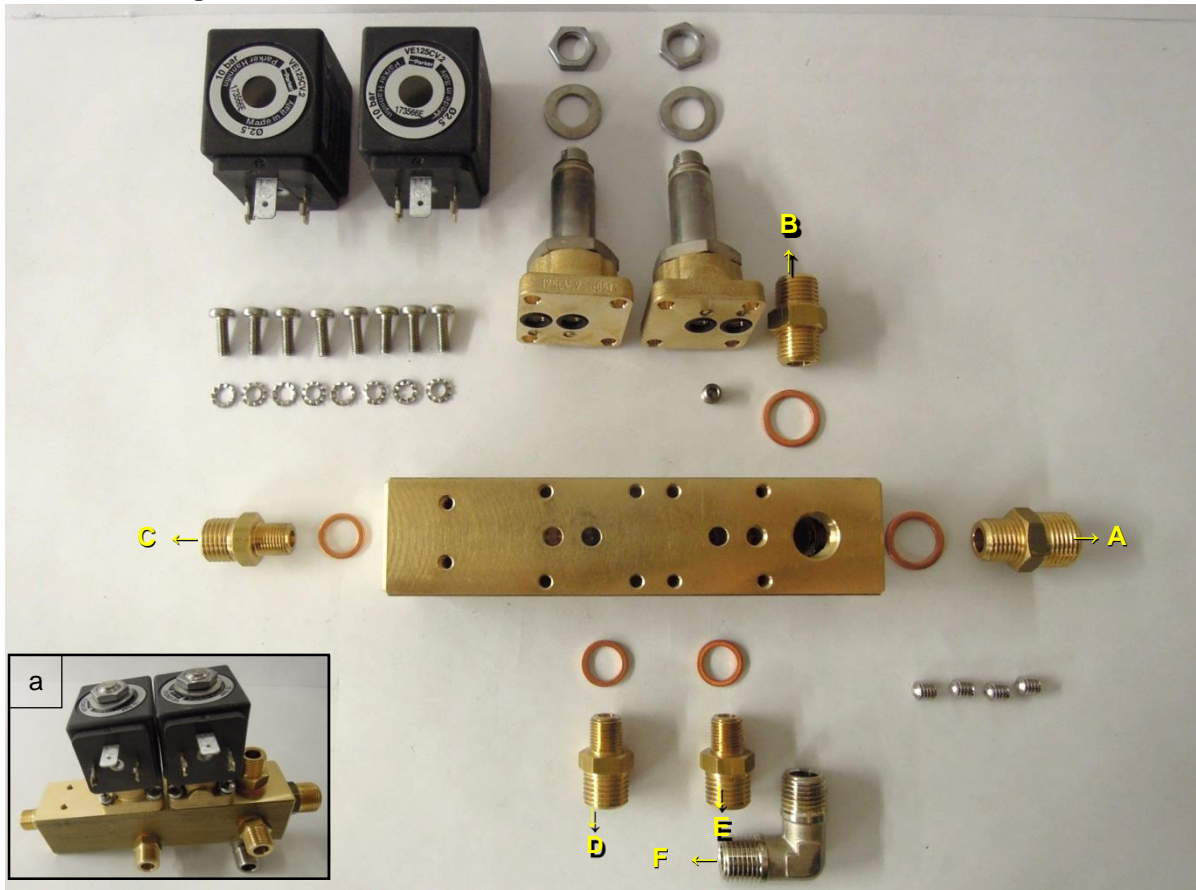

	<b>Tubing below connects to yellow arrow above</b>	<b>Number</b>	<b>remark</b>
A	copper tubing 8mm; water supply ↔ mix block	M-B040-D	Duette only
	copper tubing 8mm; water supply ↔ mix block	M-B040-T	Triplette only
B	copper tubing 2mm; mix block ↔ pump pressure gauge	M-B041	
C	copper tubing 6mm; mix block ↔ boiler	M-B044	
D	copper tubing 6mm; mix block ↔ hot water outlet	M-B045	
E	copper tubing 6mm; mix block ↔ manifold	M-B042-D	Duette only
	copper tubing 6mm; mix block ↔ manifold	M-B042-T	Triplette only
F	copper tubing 6mm; mix block ↔ boiler fill valve	M-B043-D	Duette only
	copper tubing 6mm; mix block ↔ boiler fill valve	M-B043-T	Triplette only



## Groups

### Group valve

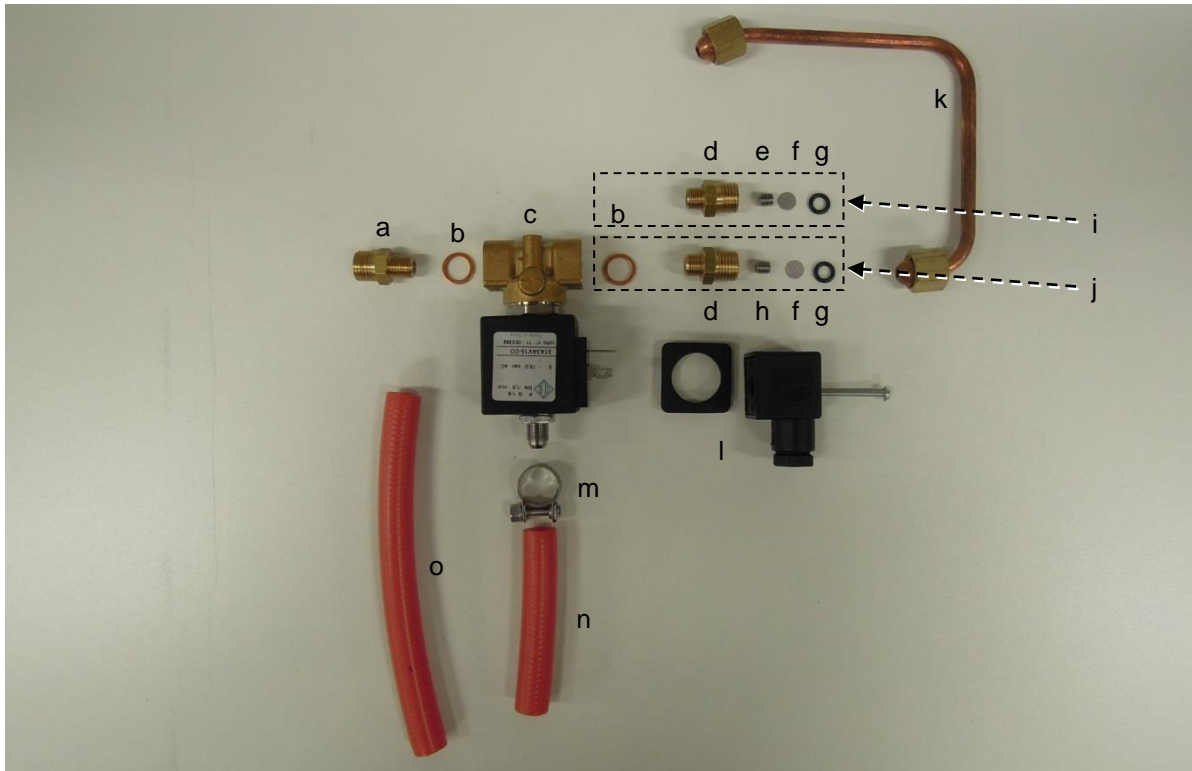

	Part	Number	remark
a	brass fitting; 1/8M-1/4M	MSR-S035	
b	copper ring; 1/8	MSR-B082	
c	brass 3-way solenoid valve with coil; 220V, 50-60Hz	M-E025	1.5mm orifice
d	brass jet housing; 1/8M-1/4M with M6 thread	MSR-S035-B	
e	s.st. jet; 0.6mm diameter, M6x6	MSR-B034-06	
f	s.st. perforated screen for jet	MSR-B036-B	
g	Viton O-ring;	MSR-G1007-A	
h	s.st. jet; 1.5 →1.0mm diameter, M6x12 (wrong picture)	MSR-B034-1L	
i	jet in housing; 0.6mm, complete	MSR-B035-C06	
j	jet in housing; 1.5→1.0mm, complete	MSR-B035-C1L	
k	copper tubing 6mm; upper group fitting ↔ group valve	M-B023	
l	solenoid coil plug with screw and seal	MSR-E024	
m	s.st. hose clamp; M7, 12-16mm	M-B071	
n	red reinforced silicone drain hose; 7.5cm	M-B070-K	left & right group
o	red reinforced silicone drain hose; 18cm	M-B070-L	middle group



## Group without progressive pre-infusion cylinder

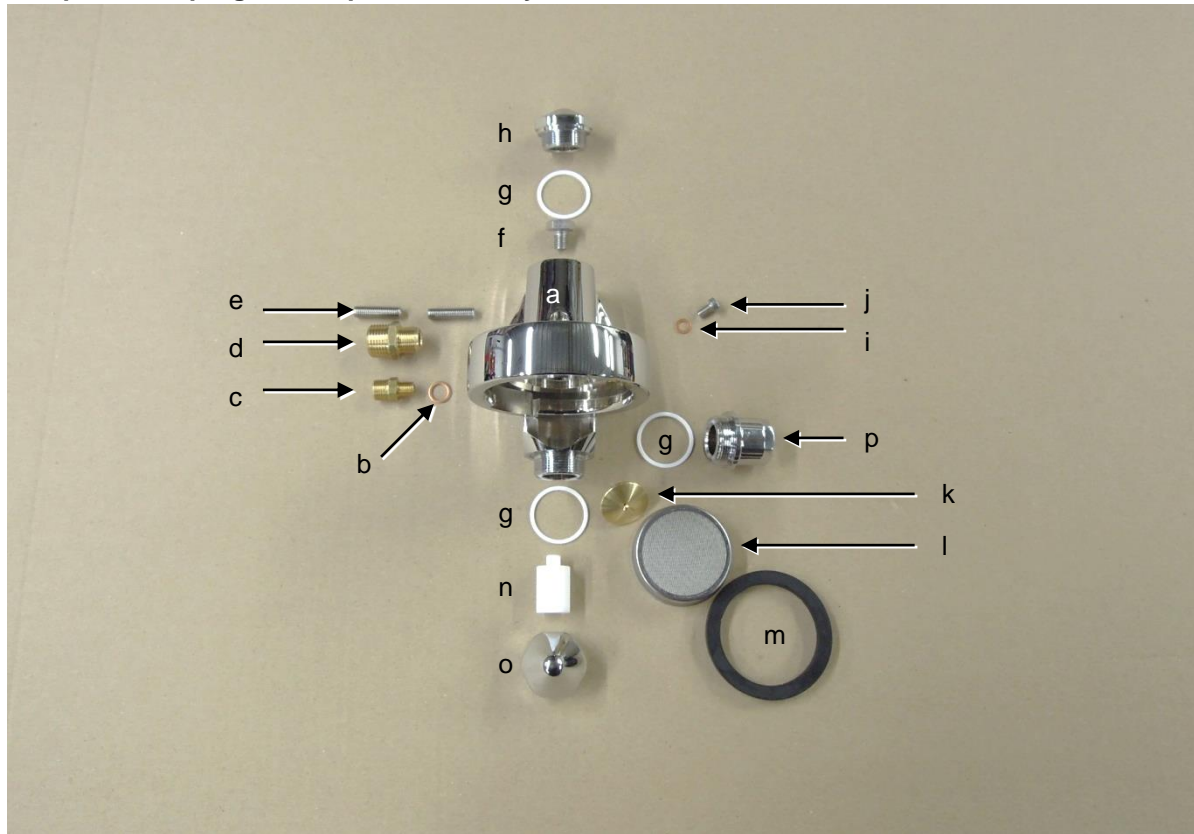

	Part	Number	remark
a	chromed brass group body; bare	M-G001	
b	copper ring; 1/8	MSR-B082	
c	brass fitting; 1/8M-1/4M	MSR-S035	
d	brass fitting; 3/8M-1/2M	M-G003-S	
e	s.st. set screw; din916 M8x30	C-SS-M8x30	
f	s.st. bolt; din933, M10x12	C-BT-M10x12	
g	Teflon O-ring; 3/4, 35x30x2	M-G007	
h	chromed brass group top cap	M-G006	
i	copper ring; 6mm	MSR-G005	
j	s.st. Allen bolt; din7984 M6x10 (low profile)	C-BL-M6x10	
k	brass diffusion plate (mushroom shaped)	M-G012	
l	s.st. group screen; KvdW logo	MSR-G013	
m	group ring; 8.0mm thick	MSR-G014-80	standard
	group ring; 8.5mm thick	MSR-G014-85	oversized, for worn out groups
	group ring; 9.0mm thick	MSR-G014-90	
n	Teflon plug	M-G011	
o	chromed brass group bottom cap	M-G010	
p	chromed brass group side cap (group without PPIC)	M-G008	NO PPIC!!
nip	chromed brass group fitting; 1/2M-3/8M, upper tubing	M-G003-L	
nip	copper tubing 6mm; group valve ↔ rear of group	M-B052	



### Group with progressive pre-infusion cylinder (PPIC)

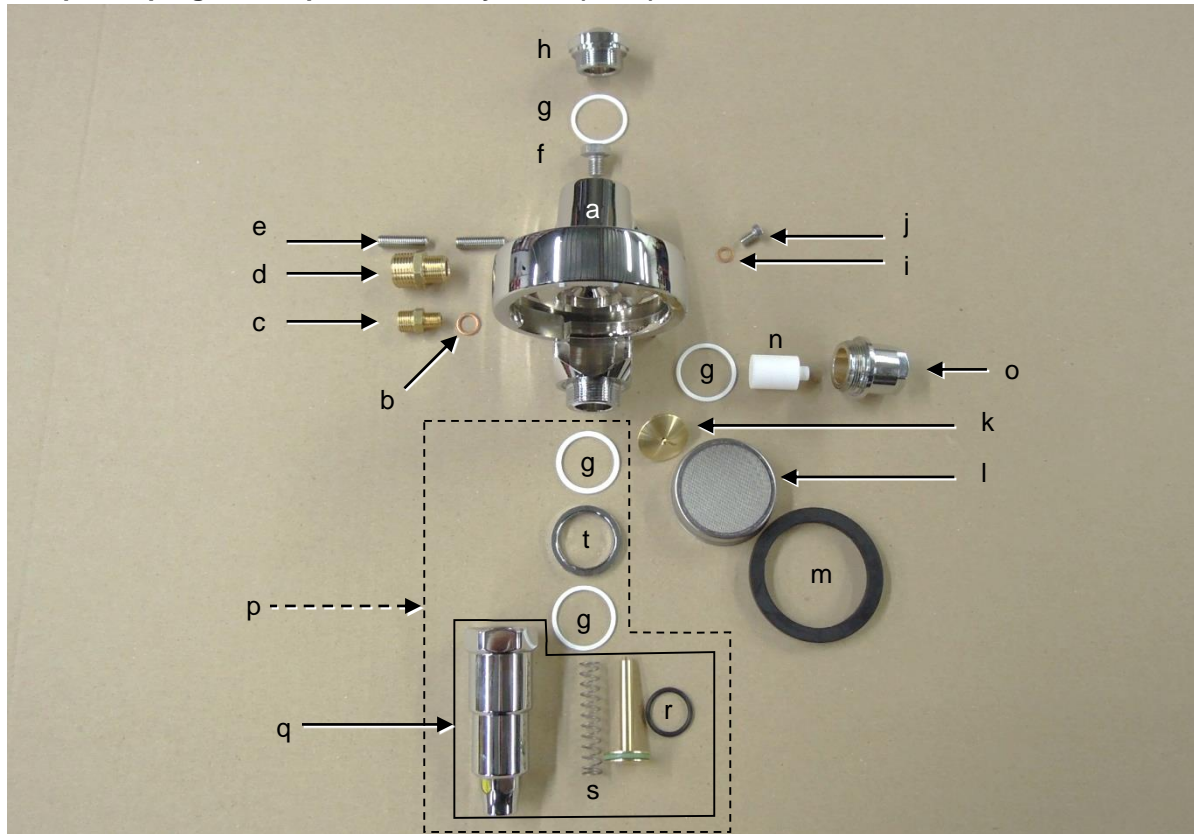

	Part	Number	remark
a..n	see previous page		
o	chromed brass group side cap (group with PPIC)	M-P019-A	
p	pre-infusion cylinder assembly	M-P013-C	
q	pre-infusion cylinder with spring, piston and O-ring	M-P012	
r	Viton O-ring on PPIC piston; 20.3x2.62	M-P016	
s	s.s.t. spring inside PPIC	M-P017	
t	chromed brass PPIC collar (spacing O-ring)	M-P018	
nip	chromed brass group fitting; 1/2M-3/8M, upper tubing	M-G003-L	
nip	copper tubing 6mm; group valve ↔ rear of group	M-B052	



# Idrocompressore

## Upper lines

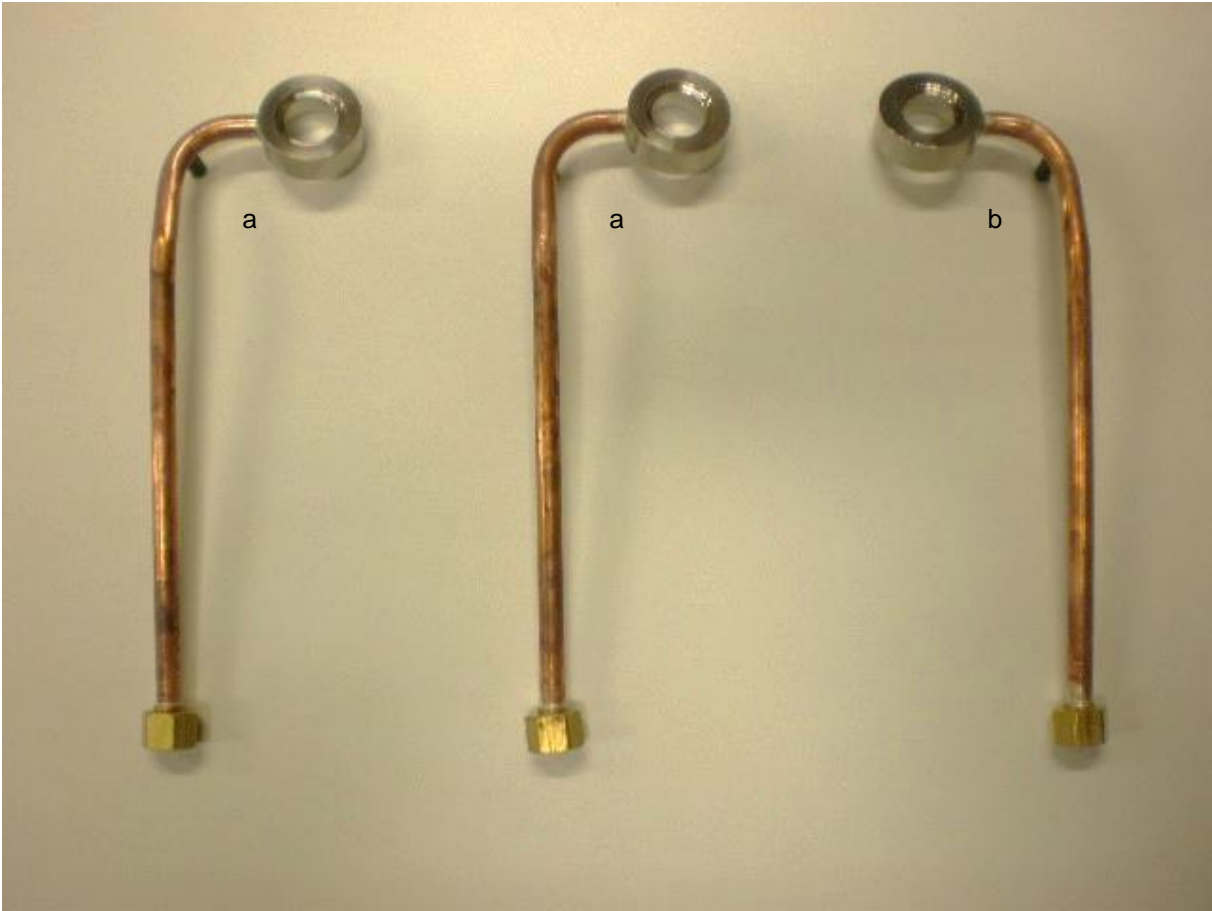

	Part	Number	remark
a	copper tubing 10mm; top HX ↔ group left (and center)	M-B120-IL	
b	copper tubing 10mm; top HX ↔ group right	M-B120-IR	



**Lower lines; flush version only**

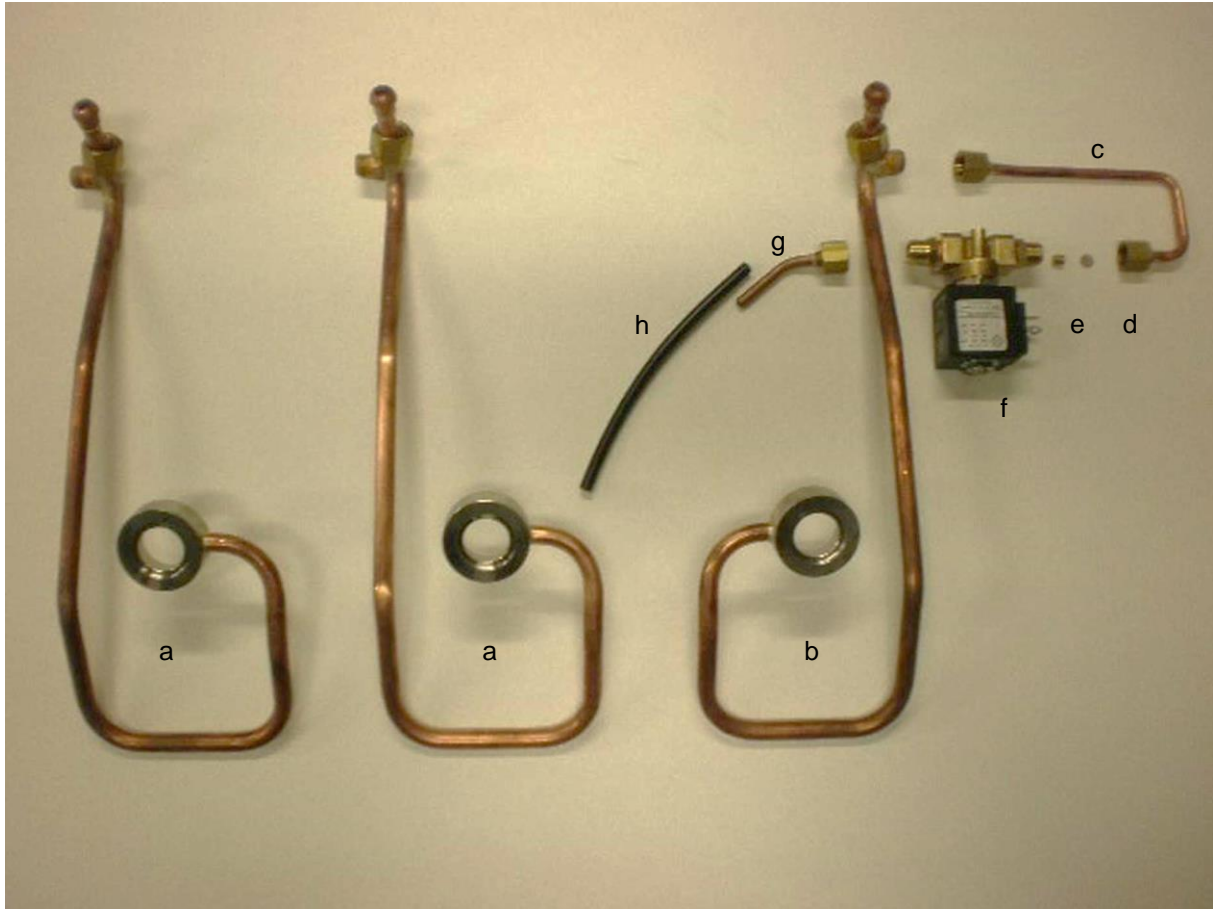

	Part	Number	remark
a	copper tubing 10mm; group left (& center) ↔ bottom HX	M-B061-IF	
b	copper tubing 10mm; group right ↔ bottom HX	M-B065-IF	
c	copper tubing 6mm; lower HX line ↔ flush valve	M-B116-IF	
nip	Viton O-ring;	MSR-G1007-A	
d	s.st. perforated jet screen	MSR-B036-B	
e	s.st. jet; 0.6mm, M6x6	MSR-B034-06	
f	brass jet housing; 1/8M-1/4M, M6 inner thread	MSR-B035-B	
	copper ring; 1/8	MSR-B082	
	brass 2-way solenoid valve with coil	M-E026	
	copper ring; 1/8	MSR-B082	
	brass fitting; 1/8M-1/4M	MSR-S035	
g	copper tubing 6mm; flush valve ↔ discharge hose	M-B115-IF	with nut
h	black silicone hose; 4x8, 30cm	M-P008-IF	



Group, until 2009

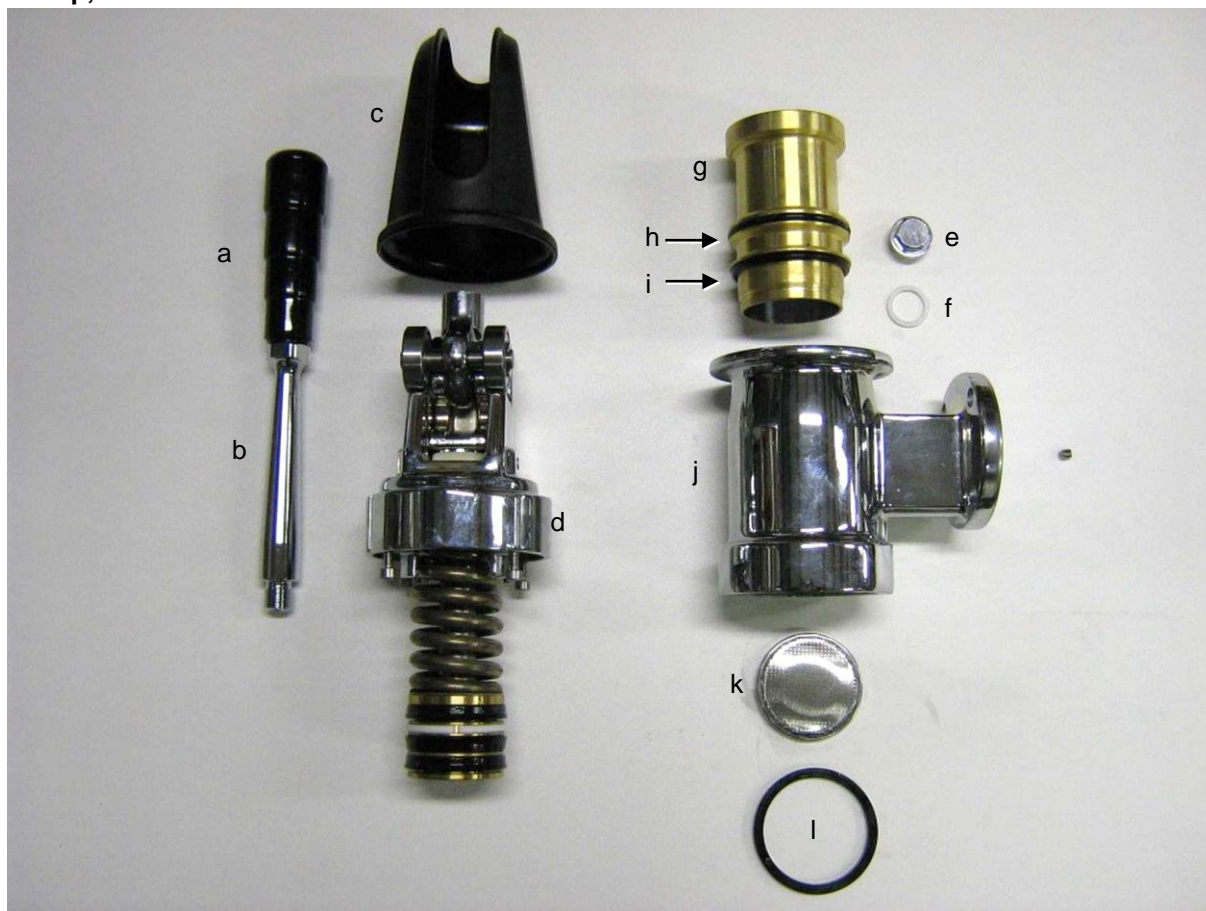

	Part	Number	remark
a	black plastic handle on lever	ZM-G046-IB	
nip	s.st. bolt in handle; din912 M8x25	C-BZ-M8x25	
	s.st. lock washer in handle; din6798A M8	C-RT-M8	
b	chromed steel lever	M-G047-I	
c	black plastic Idro group cover	ZM-G045-I	
d	complete piston/spring/swivel mechanism; Idro pre 2009	ZM-G002-I	see next page
e	chromed brass plug; M18x1.5	M-G041-I	
f	copper crush O-ring; 17.5x24.5x1.5	M-G062-I	
g	technical brass inner cylinder sleeve	M-G051-I	
h	Viton upper inner O-ring; 58.74x3.53	M-G043-I	
i	Viton lower inner O-ring;	M-G044-I	
j	chromed brass idrocompressore group; bare	M-G001-I	
k	s.st. group shower screen	M-G013-I	
l	group ring Idrocompressore	M-G050-I	



**Group interior, until 2009**

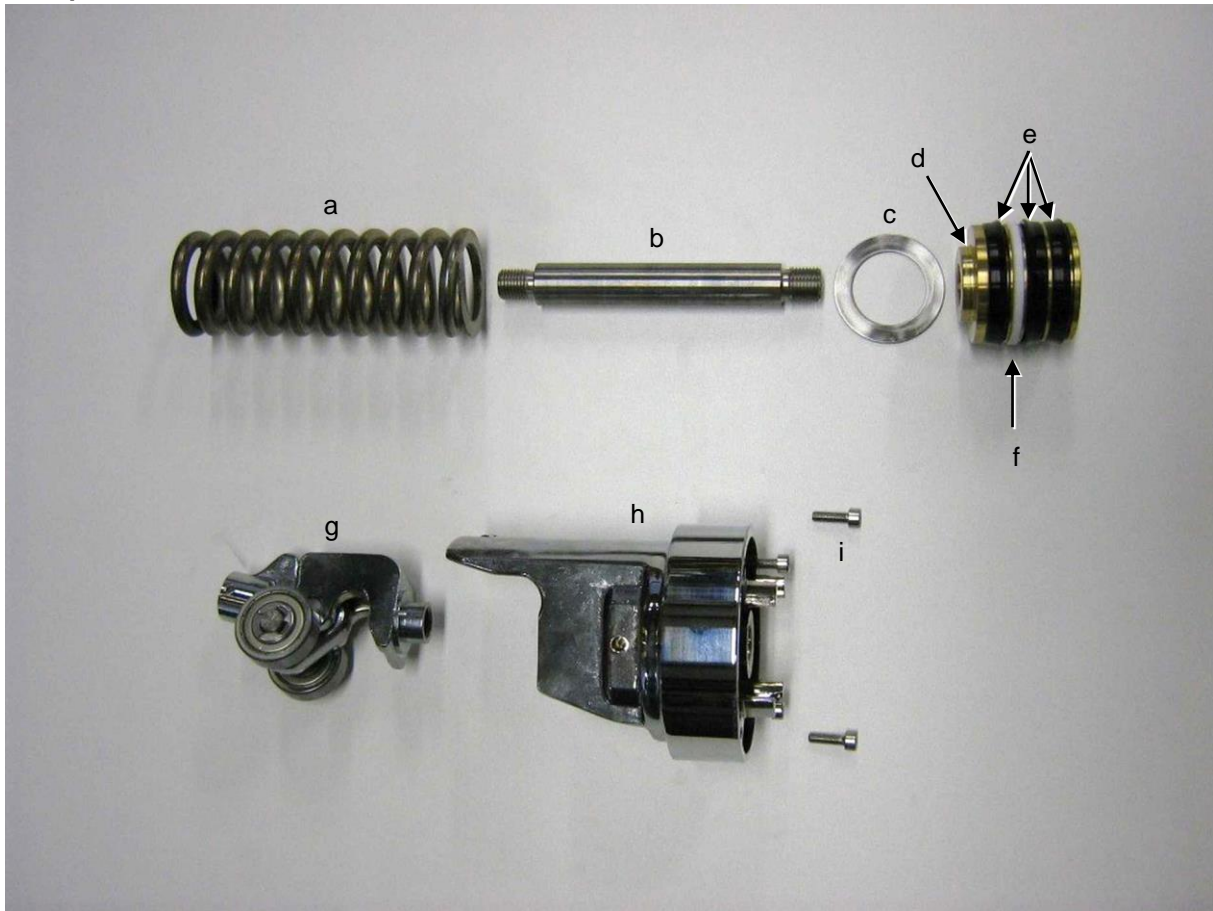

	<b>Part</b>	<b>Number</b>	<b>remark</b>
a	s.st. lever spring; Idro pre 2009	M-G053-I	
b	s.st. rod between pivot and piston; Idro pre 2009	M-G058-I	
c	s.st. O-ring between spring and piston; Idro pre 2009	M-G053-IR	
d	brass piston	M-G054-IZ	
e	Viton piston gasket; V-ring	M-G048-I	
f	Teflon open O-ring; 50x44x4	M-G049-I	
g	chromed swivel mechanism; Idro pre 2009	M-G057-I	
h	chromed brass group head; Idro pre 2009	M-G001-IU	
i	s.st. Allen bolt; din912 M5x16	C-BZ-M5x16	





Group, after 2009

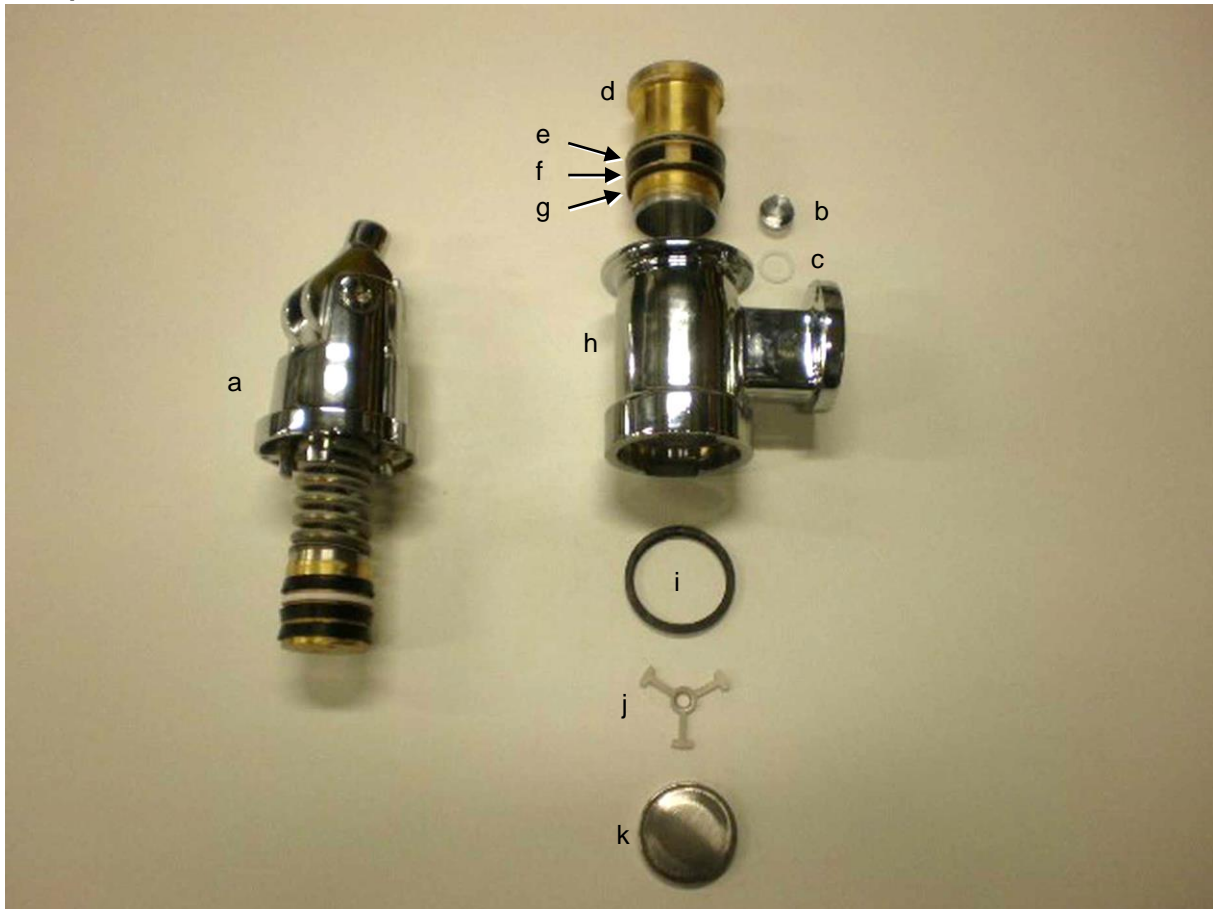

	Part	Number	remark
a	complete piston/spring/swivel mechanism	M-G002-IN	see next page
b	chromed brass plug; M18x1.5	M-G041-I	
c	copper crush O-ring; 17.5x24.5x1.5	M-G062-I	
d	technical brass inner cylinder sleeve	M-G051-I	
e	Viton upper inner O-ring; 58.74x3.53	M-G043-I	
f	black POM open ended isolation O-ring	M-G052-I	
g	Viton lower inner O-ring;	M-G044-I	
h	chromed brass idrocompressore group; bare	M-G001-I	
i	group ring Idrocompressore	M-G050-I	
j	s.st. tripod screen support Idrocompressore	M-G059-I	
k	s.st. group shower screen	M-G013-I	



Group interior, after 2009

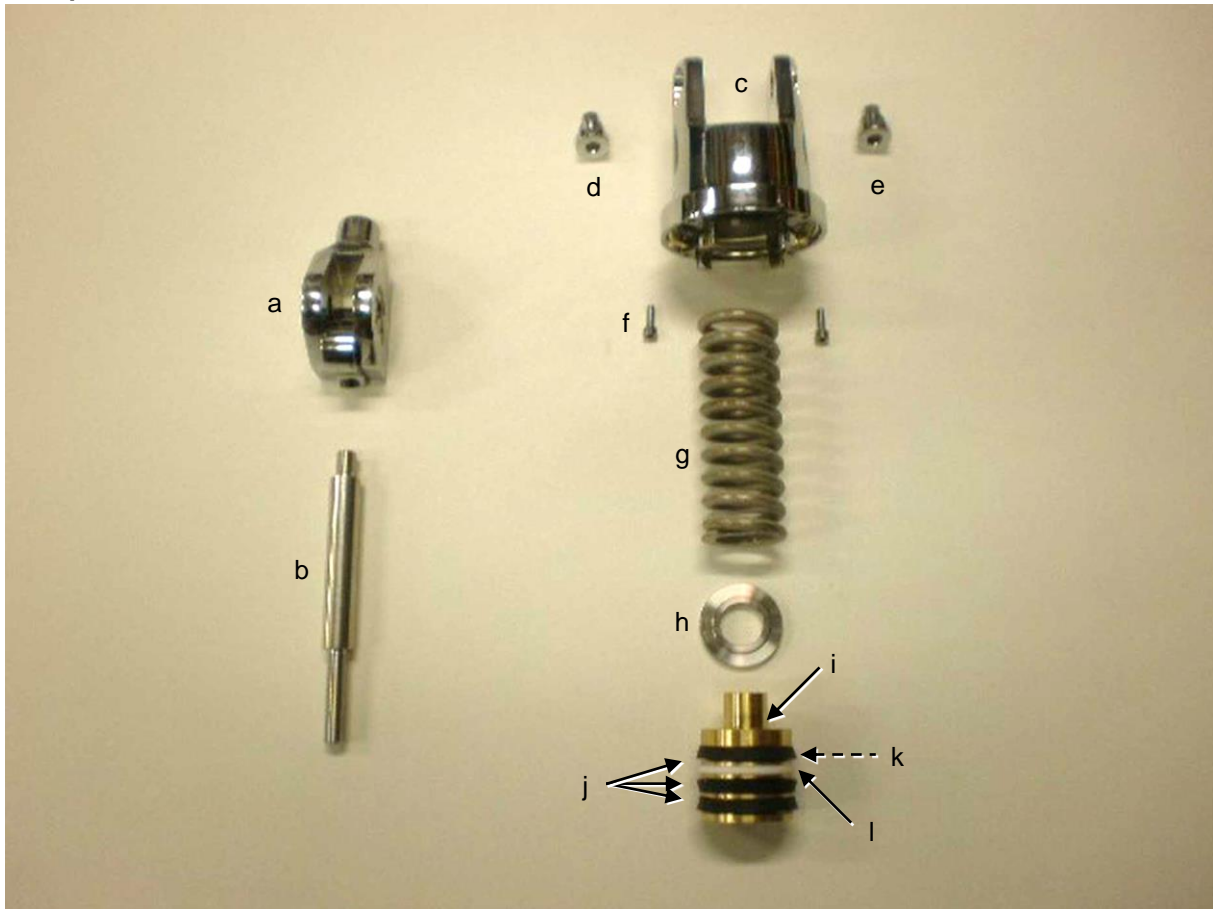

	Part	Number	remark
a	chromed swivel mechanism; new Idro	M-G004-I	
b	s.st. rod between pivot and piston; new Idro	M-G058-I	
c	chromed brass group head; new Idro	M-G001-IU	
d	chromed brass axle screw; left	M-G061-IBL	
e	chromed brass axle screw; right	M-G060-IBR	
f	s.st. Allen bolt; din912 M5x16	C-BZ-M5x16	
g	s.st. lever spring; new Idro	M-G053-I	
h	s.st. O-ring between spring and piston; new Idro	M-G053-IR	
i	brass piston	M-G054-IZ	
j	Viton piston gasket; V-ring	M-G048-I	
k	Viton O-ring in upper piston gasket; 36x3	M-G048-IO	
l	Teflon open O-ring; 50x44x4	M-G049-I	



## Manifold

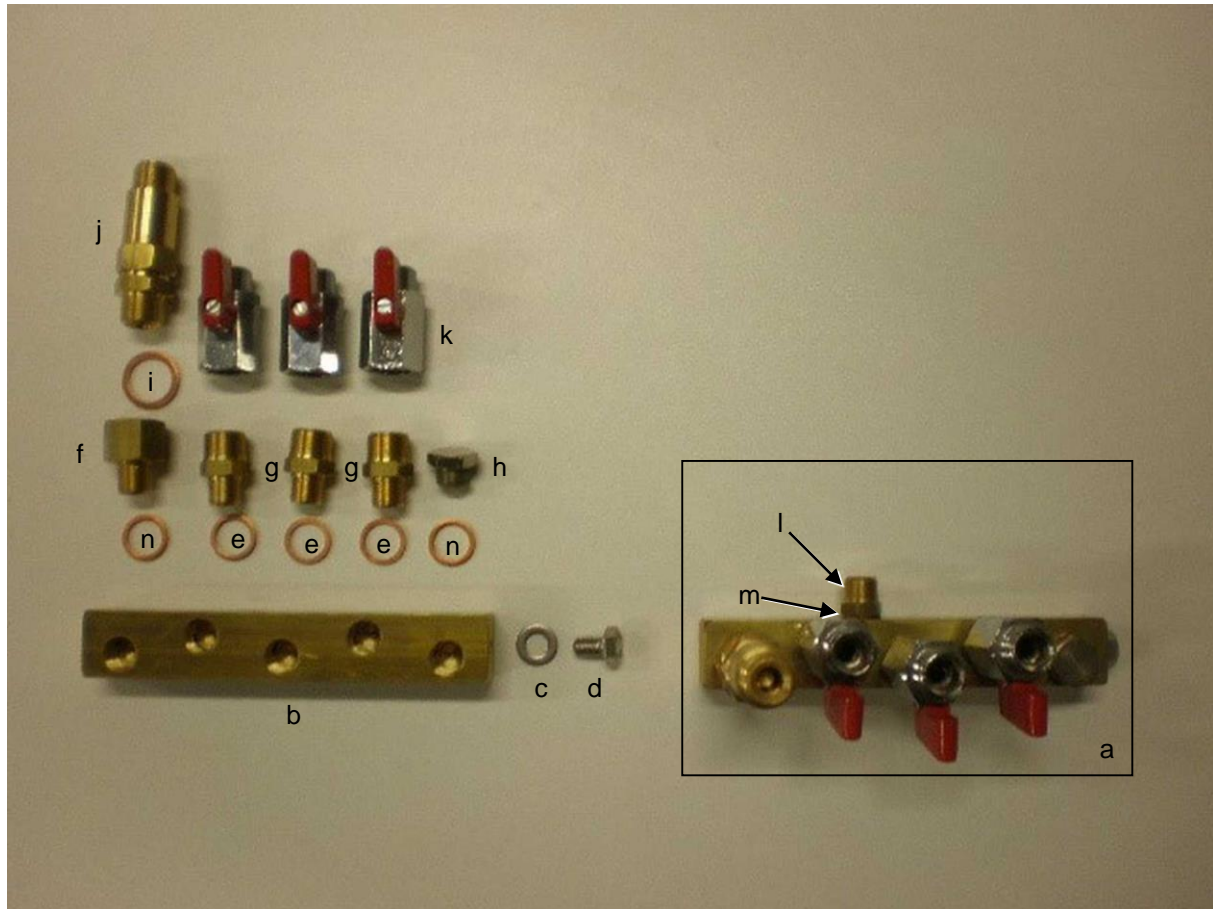

	Part	Number	remark
a	manifold Idrocompressore Triplette; complete	M-B100-ITC	
nip	manifold Idrocompressore Duette; complete	M-B100-IDC	
b	brass manifold Idrocompressore; basis	M-B100-I	
c	s.st. washer; din125A M8	C-RS-M8	
d	s.st. bolt; din933 M8x12	C-BT-M8x12	
e	copper crush ring; din7603C 2mm 13x18	C-RF-13x18	
f	brass fitting; 1/4M-3/8F	M-B010	
g	brass fitting; 1/4M-3/8M	MSR-S037	
h	chromed brass plug; 1/4M	MSR-B068	
i	copper ring; 3/8	MSR-B078	
j	brass one-way (check) valve; 3/8M-3/8M	MR-B029	
k	chromed brass ball valve; 3/8F-3/8M	M-B076-I	
l	brass fitting; 1/8M-1/4M	MSR-S035	
m	copper ring; 1/8	MSR-B082	
n	copper ring; 1/4	MSR-B079	



## Electrics

### Main controller, mains switch, timer



	Part	Number	remark
nip	Gicar main controller; Touchpad and Bastone	VMR-E017	M-E017-v2
a	Gicar main controller; new version, set for Mirage	M-E017-v2	
nip	Gicar level controller; Idrocompresso only	VM-E017-I	MS-E1017-240
b	Giemme level controller; Idrocompresso only	MS-E1017-240	
c	timer; Idrocompresso only	M-E040-I	
d	mains switch; 4x3p, 3 position, Duette and old Triplette	MR-E005	
e	mains switch; 4x4p, 3 position, Triplette and Duette high power	MR-E105	
nip	Störk ST25; steam boiler temperature controller, 240V	MSR-E1003-ST	
	Störk ST25; steam boiler temperature controller, 200V	MRS-E1005-SJ	
	s.st. pod to mount Störk ST25 under Mirage	M-F080-C	
	extension cable for temperature probe; 1100mm	VM-E1005-KM	fits left on boiler
	extension cable for temperature probe; 500mm	ZMR-E1005-KR	MR-E1005-KH
	extension cable; 575mm, angular molded plug	MR-E1005-KH	fits right on boiler
	brass Pt100 temperature probe; 1/8M, 27mm	MSR-E1005-LV	
	brass fitting; 1/8F-1/4M, to retro-fit sensor in older boiler	SR-B1067	



## Flow meter

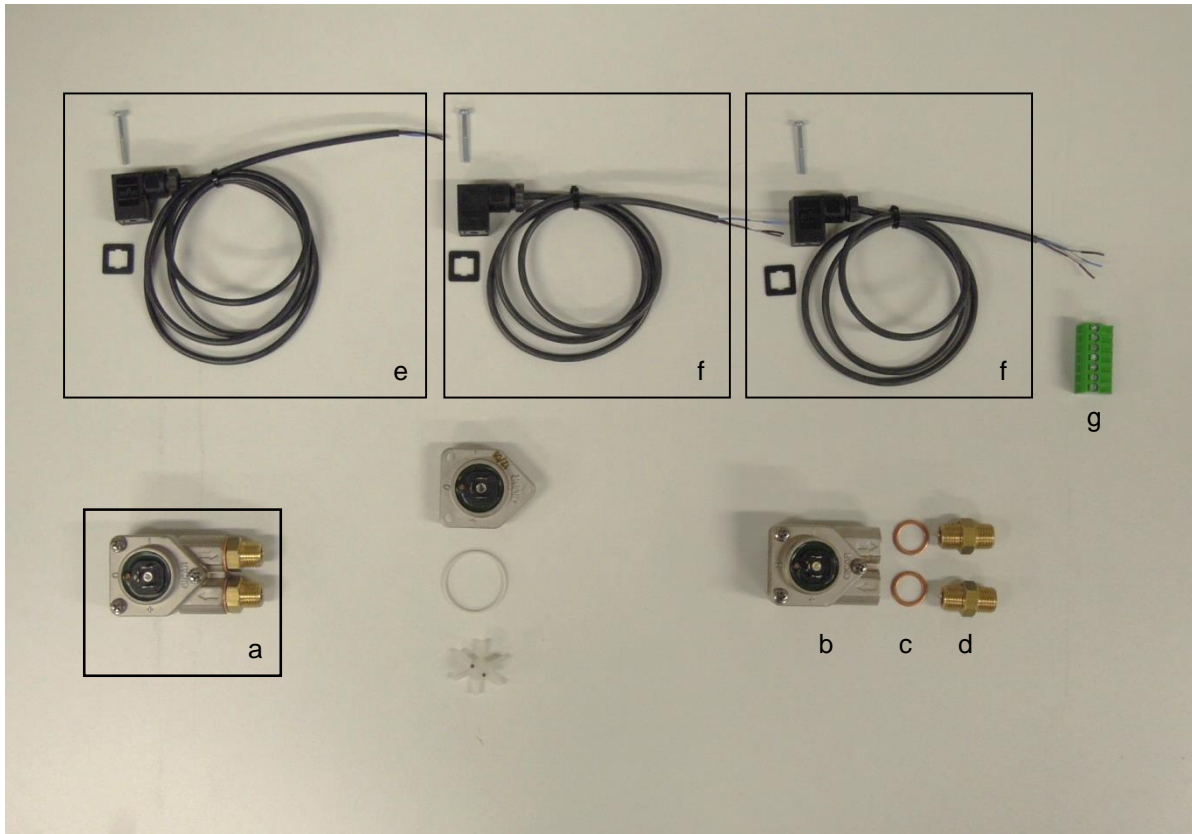

	Part	Number	remark
a	flow meter; complete with fittings	MR-E031-C	
b	nickel plated brass flow meter	MR-E031	
c	copper ring; 1/4	MSR-B079	
d	brass fitting; 1/4M-1/4M	MSR-S036	
e	flow meter cable with plug, seal and screw; 1150mm	MR-E032-T	left group Triplette
f	flow meter cable with plug, seal and screw; 850mm	MR-E032-D	all other groups
g	green 7-pole plug (part of set with 12-pole plug)	MR-E017-S	



## Touchpads, control lights, hot water switch, gauge

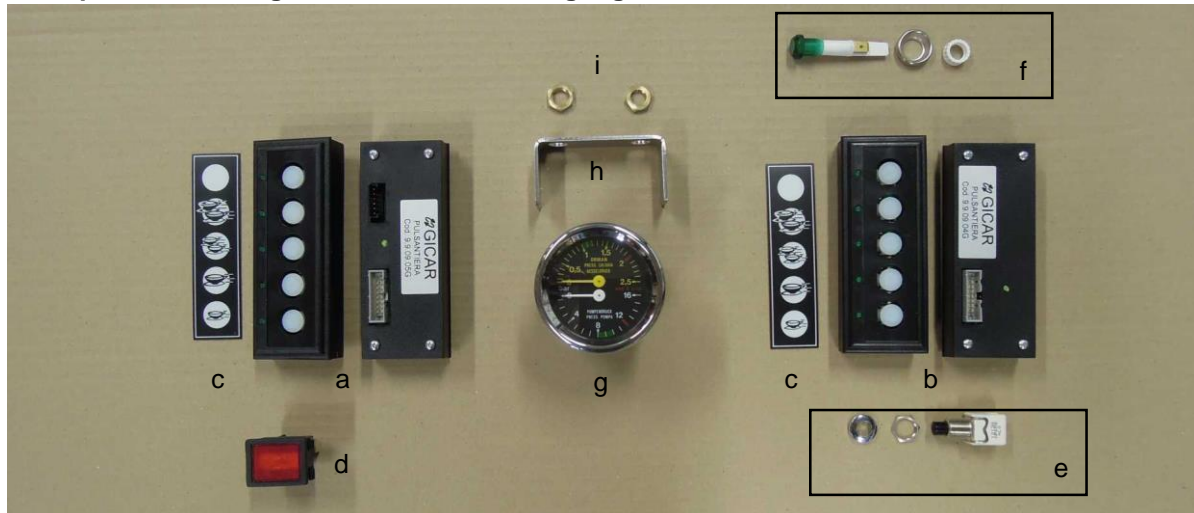

	Part	Number	remark
a	5-button touchpad with hot water connection; left group	ZM-E019	without c
b	5-button touchpad; right (and centre) group	ZM-E018	without c
c	membrane sticker "Mirage"	ZM-E018-M	
d	red indicator light; 230VAC	ZM-E012-R	
e	hot water switch; push button, black button	MR-E020-ZW	
f	green indicator light; Bastone and Idrocompresso only	ZM-E012-G	
g	dual scale pressure gauge; steam and pump pressure	ZM-B031-P	
h	s.st. bracket for pressure gauge ZM-B031-P	ZM-F020	
i	brass flat nut; 1/8	MSR-F035	
nip	single scale pressure gauge; pump pressure	MSR-B1031-PK	
	s.st. bracket for pressure gauge	MS-F1020-S	
nip	flat cable; 550mm, right group	MR-E6022-R	
	flat cable; 1100mm, left (and centre) group	MR-E022	
	flat cable; 1100mm with hot water plug, left group	MR-E022-L	new model
	hot water cable; with flat cable connector, old model	M-K003-D/T	fits on ZM-E019
	hot water cable; with flat cable connector	M-E4024	fits on MR-E022-L
nip	new model touchpad (insert)		
	new model bastone (insert)		



### Bastone lever, old model

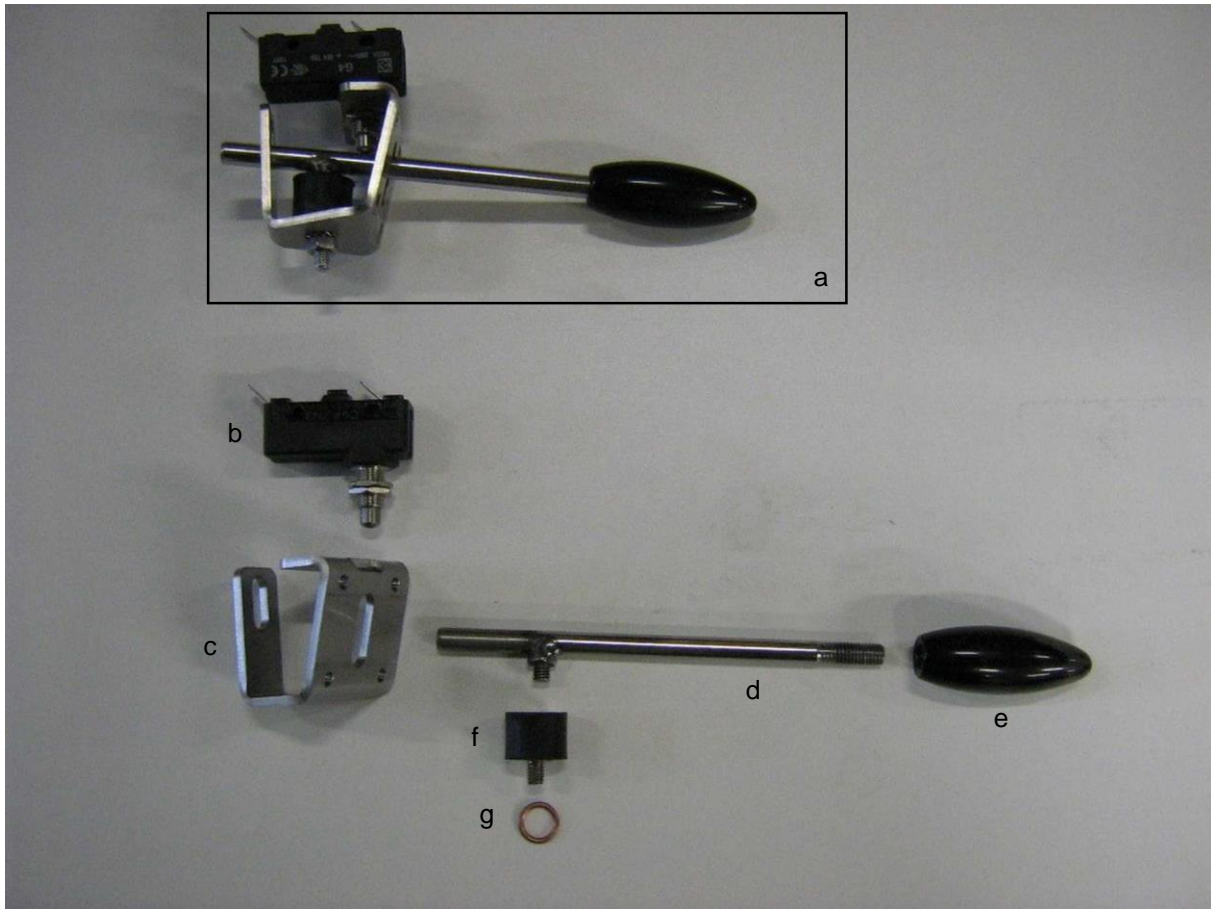

	Part	Number	remark
a	Bastone lever; old model, assembly	ZM-F045-C	
b	group switch; Mirage Bastone	MR-E039-B	
c	s.st. bracket for Bastone rod and switch	ZM-F042-B	
d	s.st. Bastone activating rod; polished	ZM-F041-B	
e	black bakelite oval knob on Bastone lever	ZM-F041-KZ	
f	vibration damper	ZM-F043-B	
g	wrong picture: should be nut on vibration damper		

There has been a hybrid version of the bastone lever between version old and new.

For the old, hybrid and new versions, some parts are still available, others are not. Please contact us before ordering.



## Bastone lever, new model

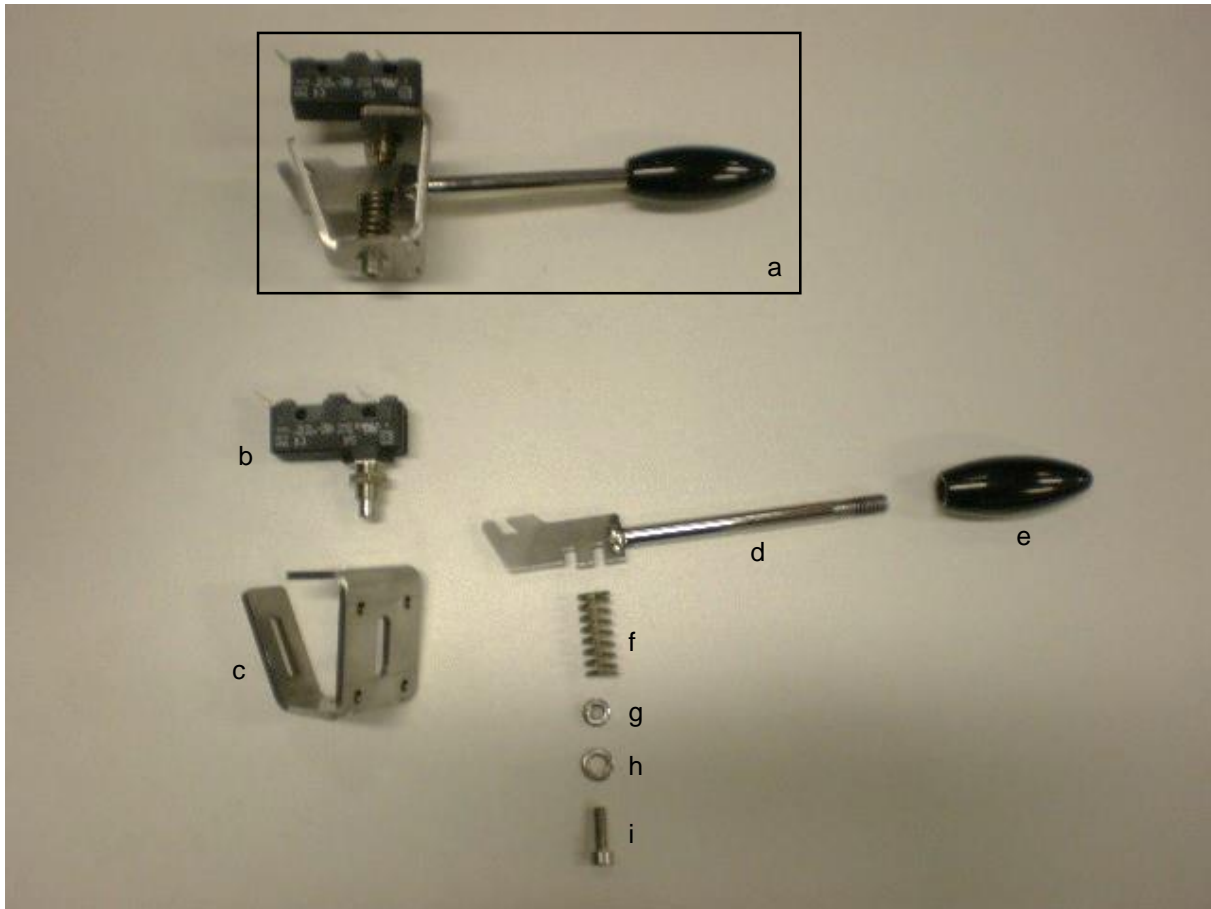

	Part	Number	remark
a	Bastone lever; new model, assembly	ZM-F045-CN	
b	group switch; Mirage Bastone	MR-E039-B	
c	s.st. bracket for Bastone rod and switch	ZM-F042-B	
d	s.st. Bastone activating rod; polished	ZM-F041-B	
e	black bakelite oval knob on Bastone lever	ZM-F041-KZ	
f	s.st. spring	MSR-S011-SP	
g	s.st. nut; din934 M5	C-MH-M5	C-MF-M5
h	s.st. washer; din125A M5	C-RS-M5	
nip	s.st. flange nut; din6923 M5	C-MF-M5	
i	s.st. Allen bolt; din912 M5x6 (wrong picture)	C-BZ-M5x6	

For the old, hybrid and new versions, some parts are still available, others are not. Please contact us before ordering.





## Heating element, SSR, pressostat

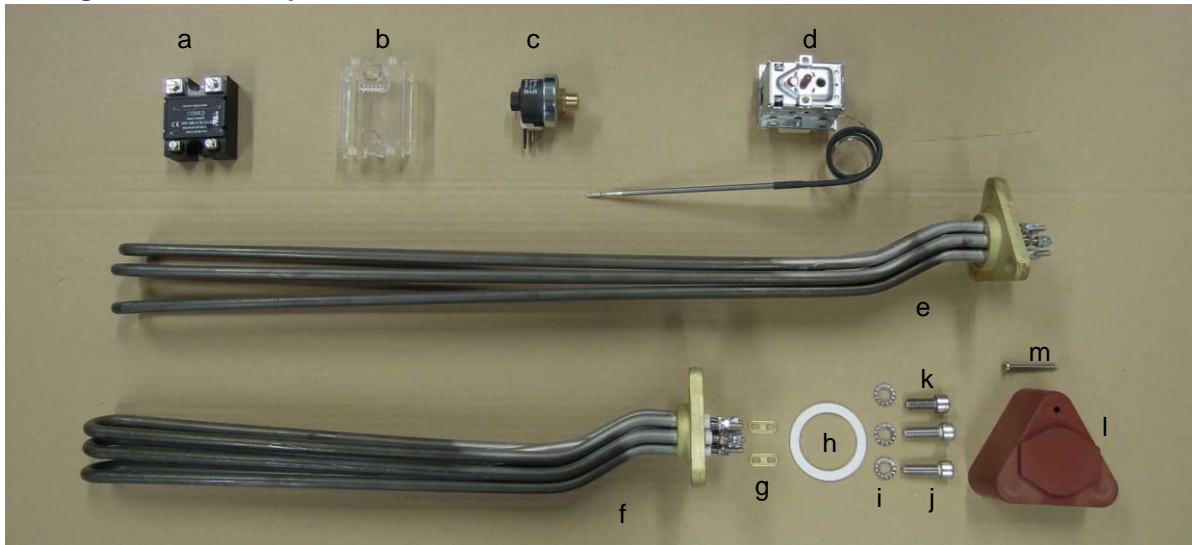

	Part	Number	remark
a	solid state relay; NO, 90-280VAC control power	MR-E008-NO	
nip	solid state relay; NO, 3-32VDC control power	MSR-E1010-NO	
b	clear plastic SSR cover	MSR-E009	
c	small pressostat; 1/4M, 1.3bar overpressure (adjustable)	ZM-E011	
d	overheat protection switch; manual reset, 155°	MR-E033-3	
e	heating element; 230VAC, 3x2000W	MR-E015	Triplette only
f	heating element; 230VAC, 3x1600W	MR-E014	Duette only
g	4mm connecting bridge on element poles	M-E035-..	specify distance
h	Teflon O-ring as gasket between element and boiler	MR-B002	
i	s.st. lock washer; din6797J M8	C-RO-M8	
j	s.st. Allen bolt; din912, M8x25	C-BZ-M8x25	
k	s.st. Allen bolt with internal M4 threads	MR-B004	
l	brown plastic element protective cover	MR-E016	
m	s.st. Philips bolt; din7985 M4x35	C-SK-M4x35	

A new version of the heating elements is in the making which uses a Viton O-ring as gasket between element and boiler. Although these elements can be exchanged with the items above, the gasket cannot.



## Valves and wands

### Steam valve and wand

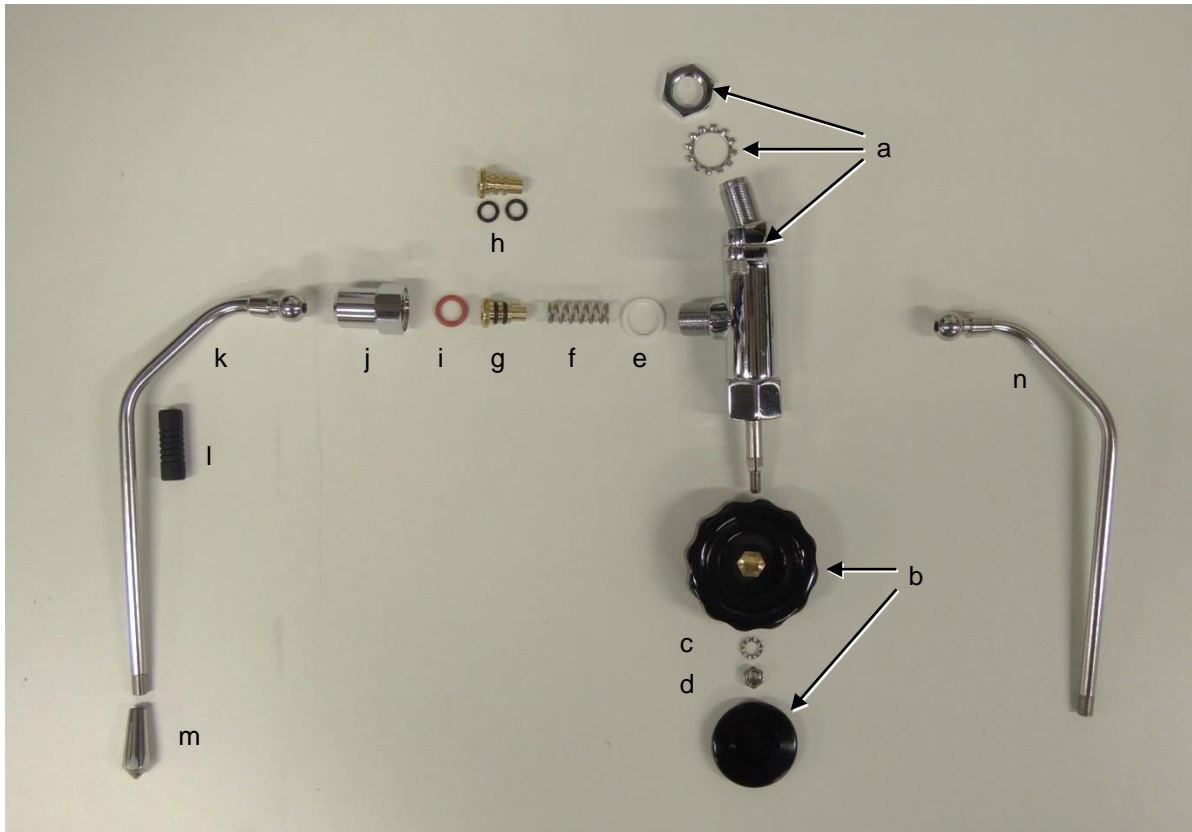

Except for the steam wand, left and right taps are identical

	Part	Number	remark
a	chromed brass steam valve with lock washer and nut	MS-S001-ST	
b	black plastic steam valve knob and cap	VMS-S002	
c	s.st. lock washer, din6798A M6	C-RT-M6	replaced by next
d	s.st. nut; din934 M6	C-MH-M6	
nip	bakelite steam valve knob; custom (tulip model)	MS-S002-v2	replaces b..d
	s.st. fender washer, din9021 M6	C-RP-M6	
	s.st. prevailing torque domed cap nut; din986 M6	C-MZ-M6	
e	Teflon O-ring; 3/8	MSR-S011-R	
f	s.st. spring; in outlet, against brass trumpet plunger	MSR-S011-SP	
g	brass plunger; complete with two O-rings	MSR-S012-ST	
h	EPDM O-ring on brass trumpet plunger; 7.2x1.9	MSR-S011-ST	set of 2 rings
i	red silicone O-ring	MSR-S013	
j	chromed bronze conical nut	MSR-S014-B	
k	s.st. steam wand; left hand side	M-S015-L	
l	anti-burn sleeve on steam wand	MSR-S031	
m	s.st. steam wand tip; 4x1.6mm	MR-S016	
n	s.st. steam wand; right hand side	M-S015-R	



## Steam valve interior

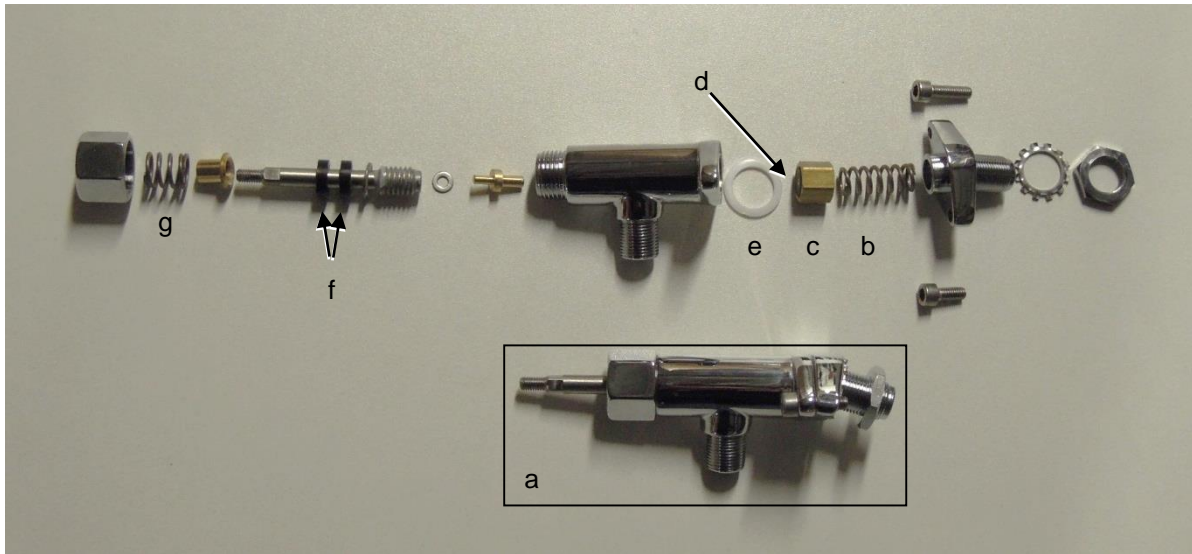

	Part	Number	remark
a	chromed brass steam valve with lock washer and nut	MS-S001-ST	
b	s.st. spring against steam plunger	MSR-F122	
c	brass plunger with Viton sealing disk	MS-S024-C	
d	sealing disk on steam valve plunger; 13x4x4	MS-S023	
e	Teflon O-ring; 24x18x2, between body and base of valve	MSR-S021	
f	sealing disk on steam valve shaft; 15.5x7.5x5x4	MSR-S025-R2	set of 2 disks
g	s.st. spring; short, in valve Mirage	MSR-F126	



## Hot water wand

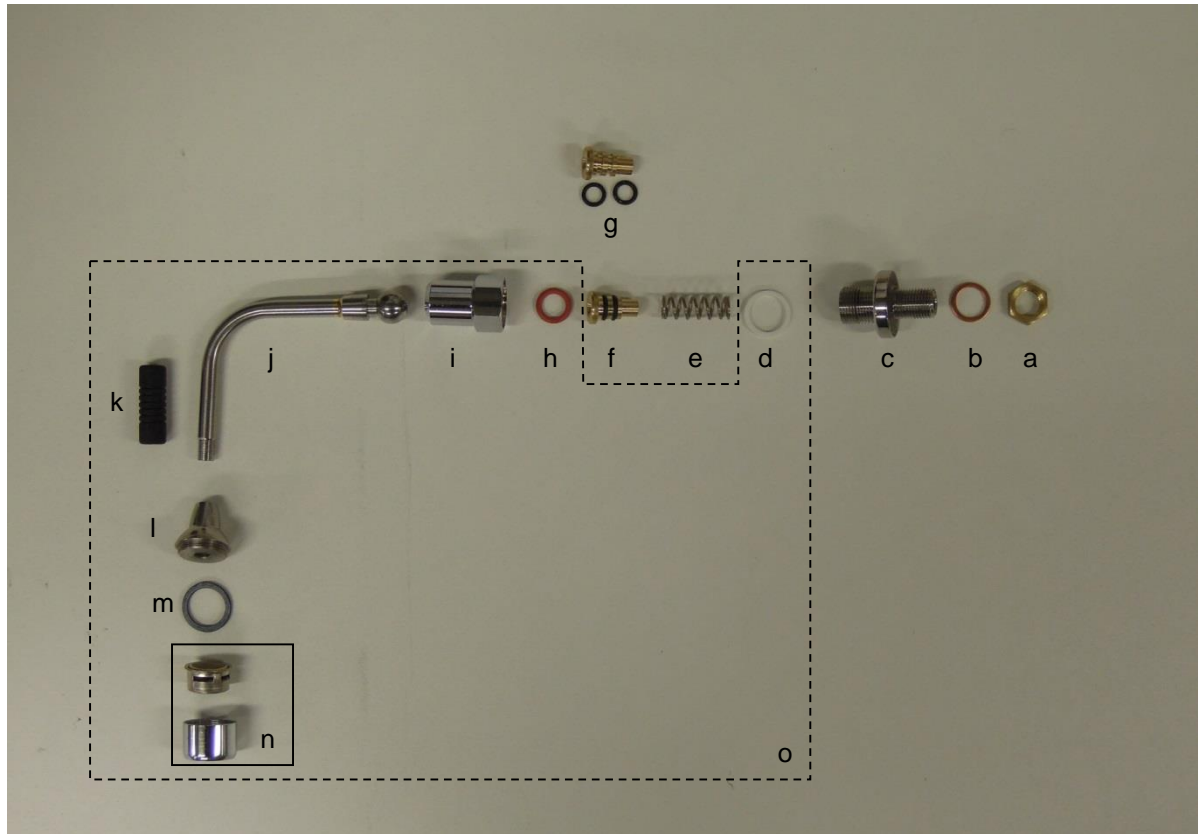

	Part	Number	remark
a	brass flat nut; 1/4	MR-S010	
b	copper ring; 1/4	MSR-B079	
c	s.st. hot water mounting block; round, no set screw	M-S019-Pv1	
nip	s.st. hot water mounting block; hexagonal, with set screw	VM-S019	
d	Teflon O-ring; 3/8	MSR-S014-R	
e	s.st. spring; in outlet, against brass trumpet plunger	MSR-S011-SP	
f	brass plunger; complete with two O-rings	MSR-S012-ST	
g	EPDM O-ring on brass trumpet plunger; 7.2x1.9	MSR-S011-ST	set of 2 rings
h	red silicone O-ring	MSR-S013	
i	chromed bronze conical nut	MSR-S014-B	
j	s.st. hot water wand	M-S017	
k	anti-burn sleeve on steam wand	MSR-S031	
l	s.st. hot water wand tip	MSR-S018	
m	EPDM O-ring in hot water screen assembly	MSR-S020-R	
n	s.st. screen assembly on hot water wand tip	MSR-S020	
o	hot water wand assembly	M-S017-C	



## Pump with motor

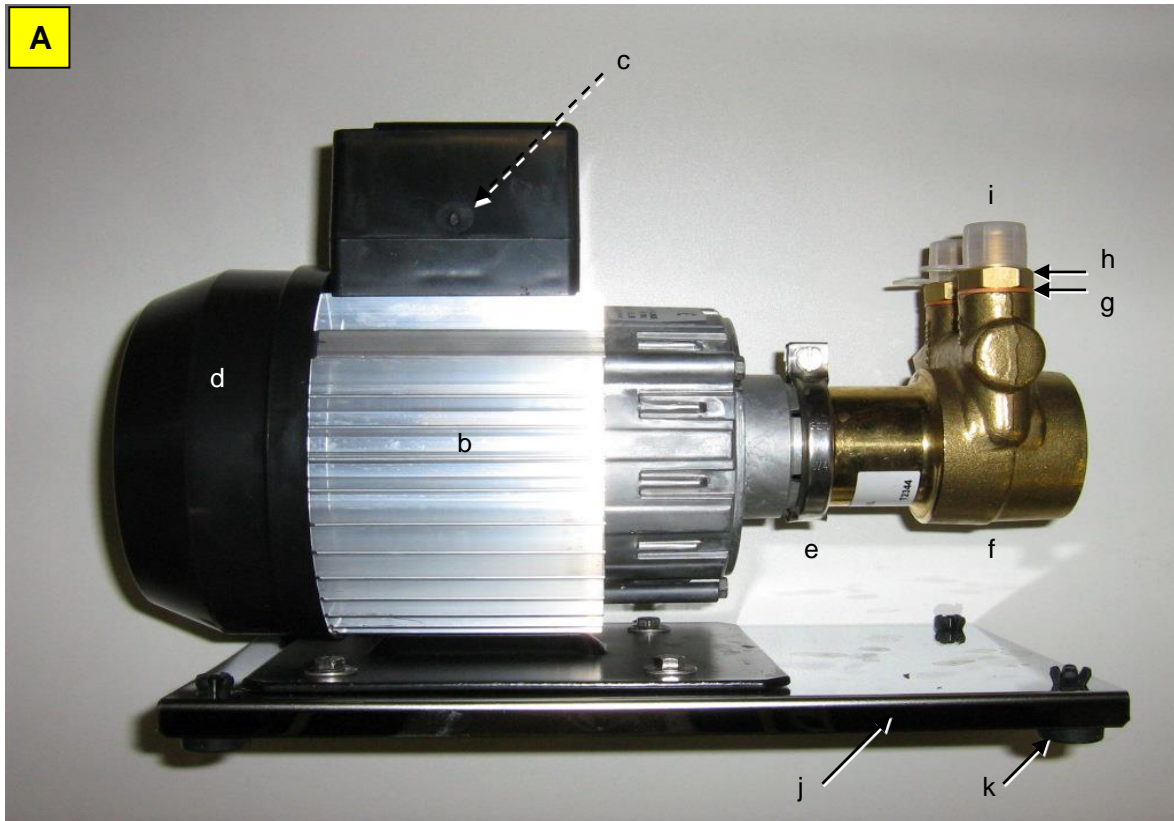

	Part	Number	remark
A	complete pump and motor assembly; 230V, 50H	MSR-A010-50H	
	complete pump and motor assembly; 200V, 50-60H	MSR-A010-200V	
	complete pump and motor assembly; 110V, 50-60H	MSR-A010-110V	
b	electric motor; 230-240VAC, 50Hz	MSR-A008-50H	
	electric motor; 200VAC, 50-60Hz	MSR-A008-200V	
	electric motor; 110VAC, 50-60Hz	MSR-A008-110V	
c	capacitor for pump 50Hz	MSR-A008-C50	
d	black plastic fan cap	MSR-A008-K	
e	s.st. clamp	MSR-A010	
f	brass rotary pump with graphite chamber and vanes	MSR-A009	
g	copper ring; 3/4	MSR-B078	
h	brass fitting; 3/8M-3/8M	MSR-A009-F	
i	clear plastic protective cap; 16.8x18.8x14.7	MSR-A008-LD	
j	s.st. base plate for pump motor	MSR-A008-B5	
k	plastic foot on base plate for motor	MSR-A008-F	



**Pump with motor; 220-240VAC, 60Hz**

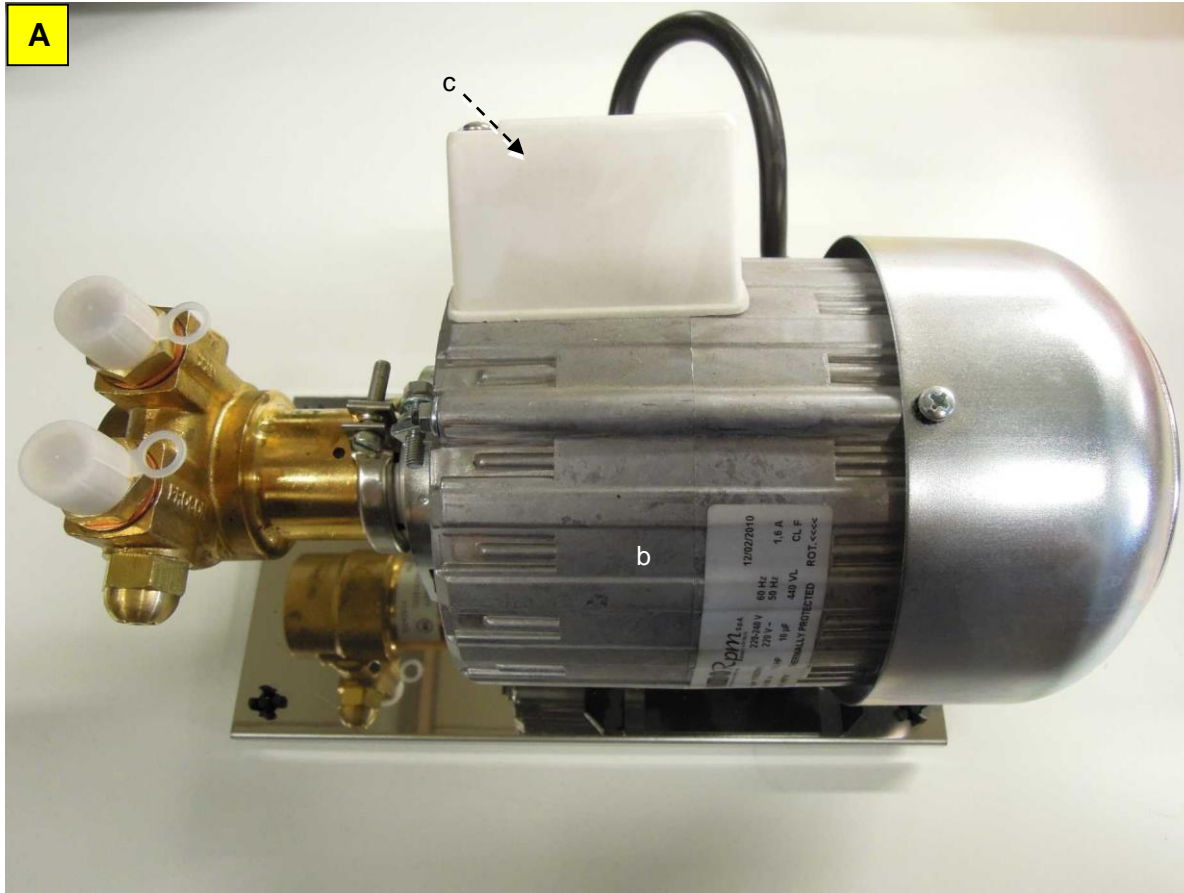

	Part	Number	remark
A	complete pump and motor assembly; 230V, 60H	MSR-A010-60H	
b	electric motor; 230-240VAC, 60Hz	MSR-A008-60H	*
c	capacitor for pump motor 60Hz	MSR-A008-C60	
nip	s.st. fixing strips for pump-motor	MSR-A008-B6	
* fan cap not sold separately			
all other parts as on previous page			



## Foot operated steam valve

### Pedal parts

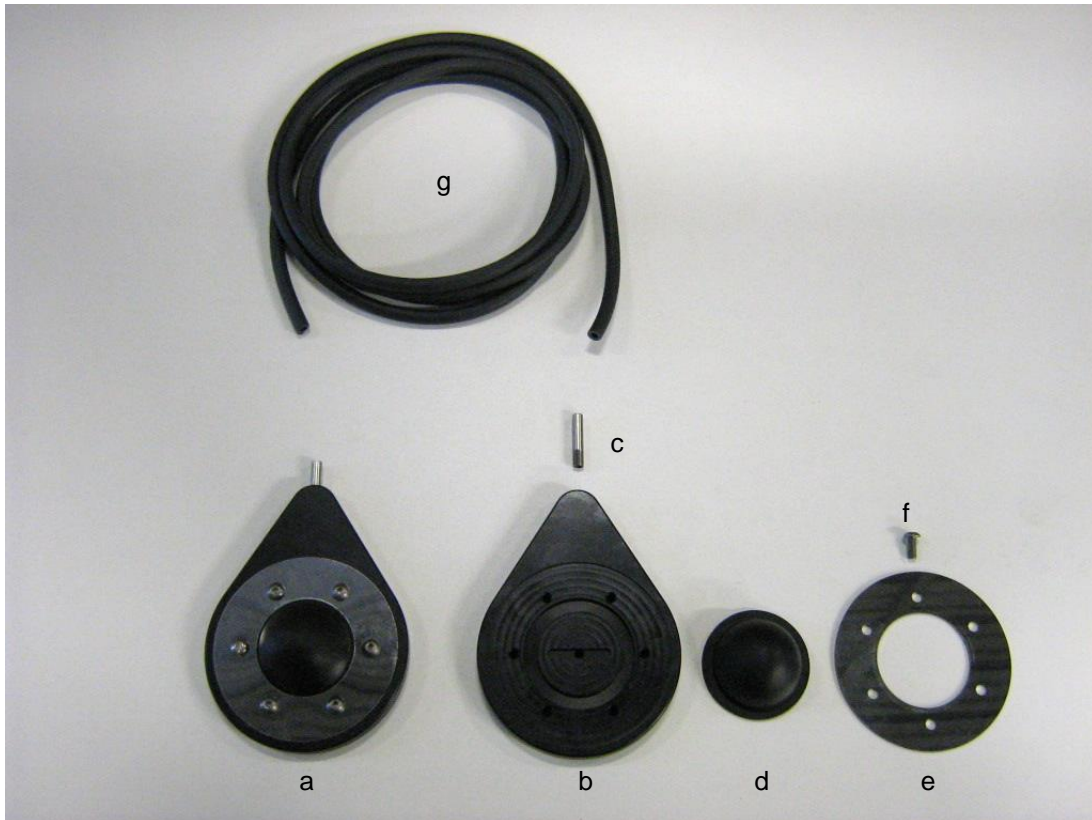

	Part	Number	remark
a	foot operated air-pedal; complete	MSR-P001-C	
b	black PVC pedal base	MSR-P003	
c	s.st. threaded tube to fit air-hose; M6x0.75	MSR-P006	
d	black rubber half-ball on air-pedal	MSR-P002	
e	s.st. ring holds half-ball on base	MSR-P004	
f	s.st. Allen bolt; iso7380 M5x12	C-BI-M5x12	
g	rubber air hose; 4x8, 2.5m long	MSR-P007	



## Other parts

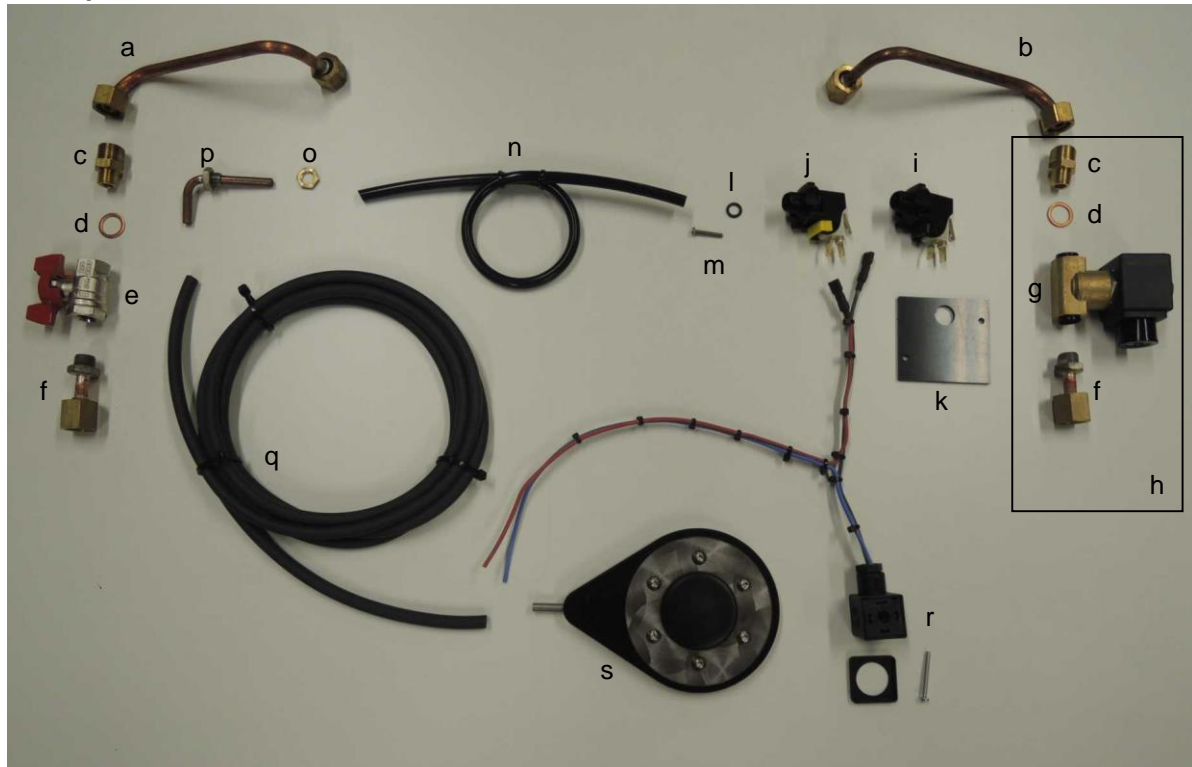

	Part	Number	remark
a	copper tubing 8mm; steam boiler ↔ steam valve left	M-B057-L	
b	copper tubing 8mm; steam boiler ↔ steam valve right	M-B057-R	
c	brass fitting; 1/4M-3/8M	MSR-S037	
d	copper ring; 1/4	MSR-B079	
e	nickel plated brass ball valve; butterfly handle, 1/4F-1/4F	MSR-B076	
f	copper tubing 8mm; steam valve ↔ steam tap	MR-B058	
g	brass 2-way solenoid valve; 230V 50-60H, 6mm orifice	VMSR-E027	MSR-E4027
h	solenoid valve with coil (230V), fitting and tubing	XMSR-E027-C	
nip	brass 3-way solenoid valve; 5mm orifice, capped	MSR-E4027	
nip	c + d + f + MSR-E2027	MR-S058-EC	
i	air switch; alternating (tap-on, tap-off)	MSR-E030-A	
j	air switch; momentary (tap=on, release=off)	MSR-E030-M	
k	black POM air switch retrofit plate	M-E030-RP	
l	EPDM O-ring; 7.2x1.9	MSR-S011-ST	set of 2 O-rings
m	s.st. machine screw; din84 M3x20	C-SG-M3x20	
n	black silicone hose; air switch ↔ stress release	MSR-P008	C-HS-ZZ4x8 42cm
o	brass flat nut; 1/4	MSR-S010	
p	copper tubing 6mm; stress relief connector	MSR-B017	
q	black chloroprene hose; stress relief ↔ foot pedal	MSR-P007	C-HR-ZZ4x8 2.5m
r	wiring with plug, seal and screw	M-K004	
s	foot operated air-pedal; complete	MSR-P001-C	





## Milk pitcher tray

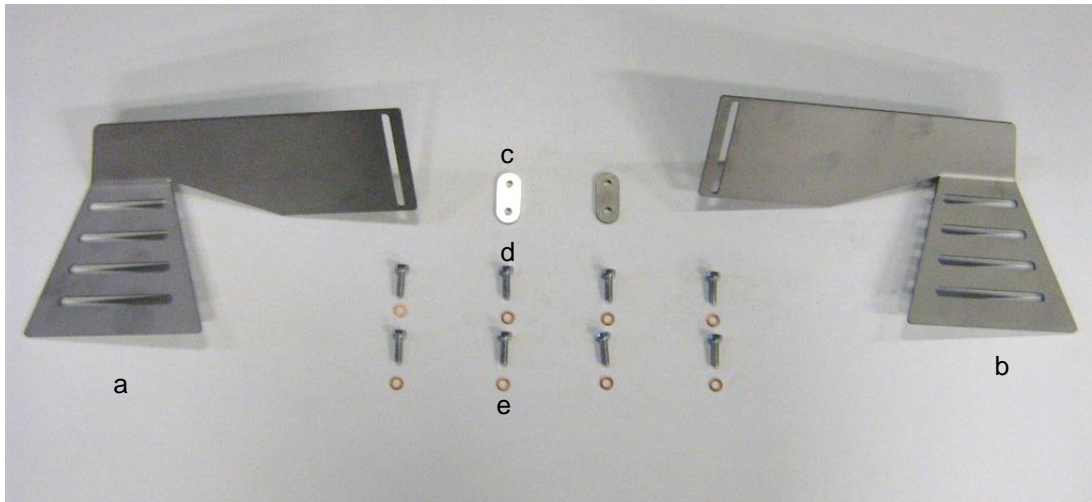

	Part	Number	remark
a	s.st. pitcher tray; left hand side, sand blasted	M-F063-L	
b	s.st. pitcher tray; right hand side, sand blasted	M-F063-R	
c	s.st. oval spacer; 3mm thick, sand blasted	M-F063-O	
d	s.st. bolt; din933 M6x20	C-BT-M6x20	replace M6x12!
e	copper ring; M6	MSR-G005	
nip	s.st. universal pitcher tray support; bead polished	M-F4063	fits both sides
	s.st. universal pitcher tray; bead polished	M-F4063-U	fits both sides
	s.st. ovals pacer; 3mm thick, bead polished	M-F4063-O	



## Body parts

to be completed

	Part	Number	remark
a			
b			
c			
d			
e			
f			

